

high-lowTM

high-low:xTM

English manual

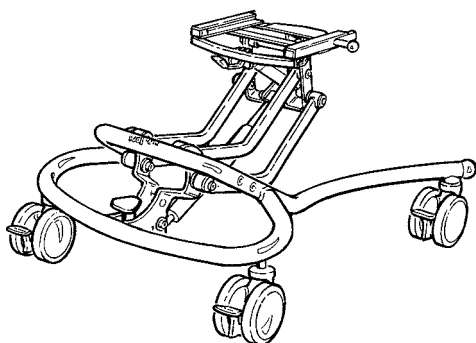

High-low indoor frame

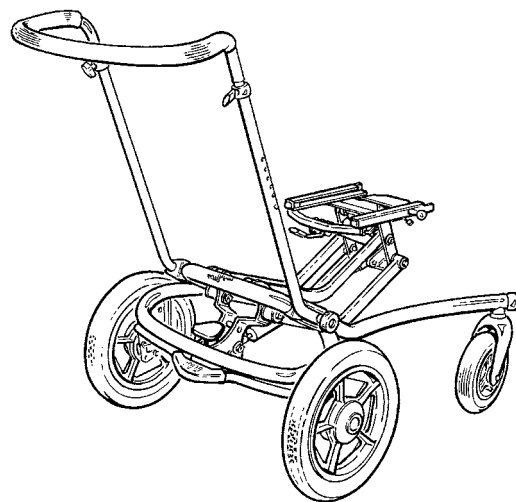

High-low outdoor frame

INTENDED PURPOSE

The High-low and High-low:x frames are stable bases with a user friendly height adjustment from floor to table height. The Frames come in 2 versions.

A wide selection of seats can be combined with the frame . Please go to http://www.r82.org/media/102124/frame_and_seat_combination.pdf for more information about combinations.

Indoor use

High-low indoor frame: EN 12182

High-low:x indoor frame: EN 12182

Outdoor use

High-low outdoor frame: EN 12182 and 12183

High-low:x outdoor frame: EN 12182 and 12183

This User Guide will enable you to take full advantage of the many possibilities the product has.

CONTENTS

Intended Purpose	2
Frame/Seat.....	4
Frames	5-10
Push brace for indoor frame	11
Push brace for outdoor frame.....	11
Adjusting the "Wombat" foot plate	11
Adjusting the individual foot supports.....	12
Individual foot supports for x:panda.....	12
Gasspring adjustment.....	13
Transport Fittings.....	14
Product identification	14
Declaration of Conformity	15
R82 Warranty	15
Safety	15
Service information.....	16
Presales information.....	16
Power unit	17
Disposal.....	17
EMC.....	18-19
Symbols.....	20
Measures.....	21
Technical data.....	21
Producer.....	21
Distributor	21
Lifting and Transfer.....	22

Seat \ Frame	High-low indoor/ outdoor	High-low:x indoor			High-low:x outdoor	
	one sz.	sz. 1	sz. 2	sz. 3	sz. 1	sz. 2
Panda Futura sz. 1	●	○	○		○	
Panda Futura sz. 2	●	○	○		○	
Panda Futura sz. 2½	●	○	○		○	
Panda Futura sz. 3	●	○	○	○	○	
Panda Futura sz. 4	●	○	○	○	○	
Panda Futura sz. 5*			○	●		
x:panda sz. 1 - S	○	●			●	
x:panda sz. 1 - M	○	●			●	
x:panda sz. 1 - L	○	●			●	
x:panda sz. 2 - S	○	●			●	
x:panda sz. 2 - M	○	●			●	
x:panda sz. 2 - L	○	●			●	
x:panda sz. 3 - S			●	●		●
x:panda sz. 3 - M			●	●		●
x:panda sz. 3 - L			●	●		●
x:panda sz. 4 - S				●		
x:panda sz. 4 - M				●		
x:panda sz. 4 - L				●		

- Recommendation
- Possibility

* We also recommend the Combi Frame for Panda Futura 5 (please see separate user guide).

HIGH-LOW SZ. 1 HIGH-LOW:X SZ. 1+2 INDOOR FRAME

The instructions below are for High-low and for High-low:x.

The frame is height adjustable from floor to table height. When pressing the footpedal (A) the height is adjusted individually. The foot pedal is equipped with a security lock (B). Turn the lock to the left and it is activated, turn it to the right and it is deactivated.

! Be careful when lowering this frame from the highest position to the lowest because of the risk of finger entrapment etc.

! If the the chair has to be used in the lowest position, the foot rest has to be removed first.

Further, angle the adaptor by lightly pressing down the handle (C) and pushing against the seat back.

! The handle is also equipped with a security knob. This must be deactivated before use.

! It is important to press down on the back while the seat is angled to ensure a slow angling.

Let go of the handle and the seat is "locked" in the wanted position. Activate the security knob.

All four wheels have brakes (D).

The height adjustment can be made both with or without a seat on the frame.

! The High-low/High-low:x indoor frame is only for indoor use.

! When mounting a Panda Futura size 4 on a High-low/High-low:x frame, you **MUST** mount anti-tip device (E).

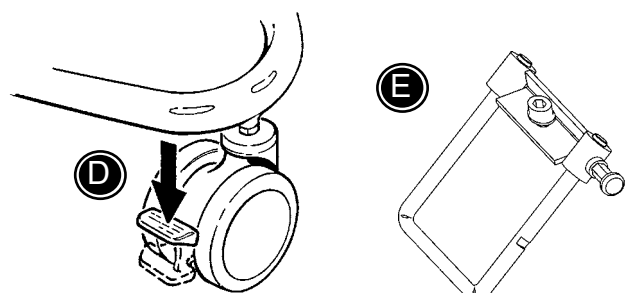
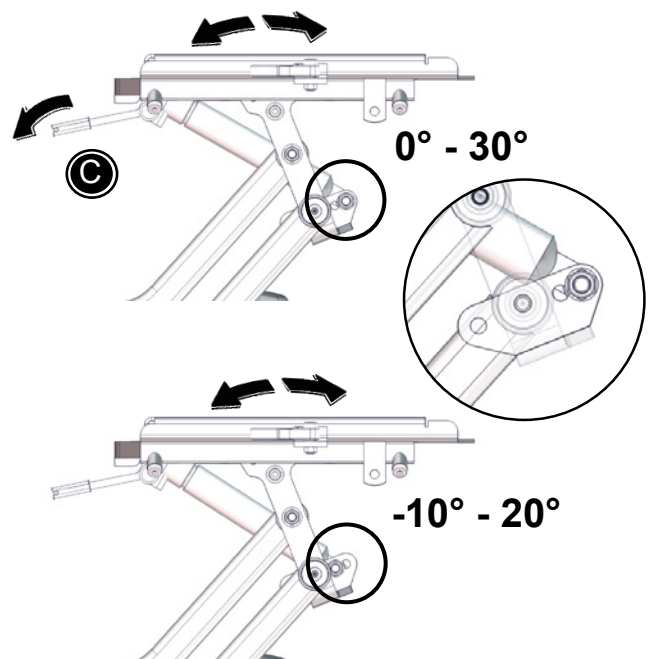
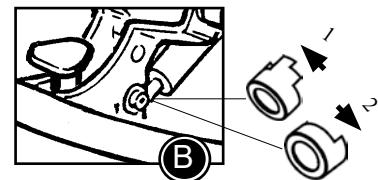
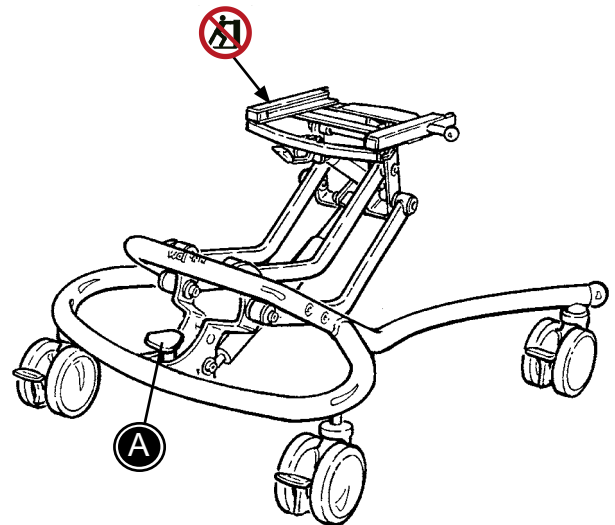

HIGH-LOW SZ. 1 HIGH-LOW:X SZ. 1+2 OUTDOOR FRAME

The instructions below are for High-low and for High-low:x.

The frame is height adjustable from floor to table height. When pressing the foot pedal (A) the height is adjusted individually. The foot pedal is equipped with a security knob. Turn the lock to the left and it is activated, turn it to the right and it is deactivated.

! Entrapment Hazard! be careful not to get anything caught between the frame and foot pedal when pressing the foot pedal downwards

! Be careful when lowering this frame from the highest position to the lowest because of the risk of finger entrapment etc.

! If the the chair has to be used in the lowest position, the foot rest has to be removed first.

Further, angle the seat by lightly pressing down the handle (B) and pushing against the seat back.

! The handle is also equipped with a security knob. This must be deactivated before use.

! It is important to press down on the back while the seat is angled to ensure a slow angling.

Let go of the handle and the seat is "locked" in the wanted position. Activate the security knob.

Activate the brake with the foot (C).

The frame is very easy to fold (D). Activate the footpedal (A) and the seat unit can be pushed down to floor height. Then loosen the handles (E) at both sides and fold the handbrace. The push brace is adjustable in height (F).

! The High-low/High-low:x outdoor frame is approved for transportation of children in vehicles.

! When mounting a Panda Futura size 4 on a High-low/High-low:x frame, you **MUST** mount anti-tip device.

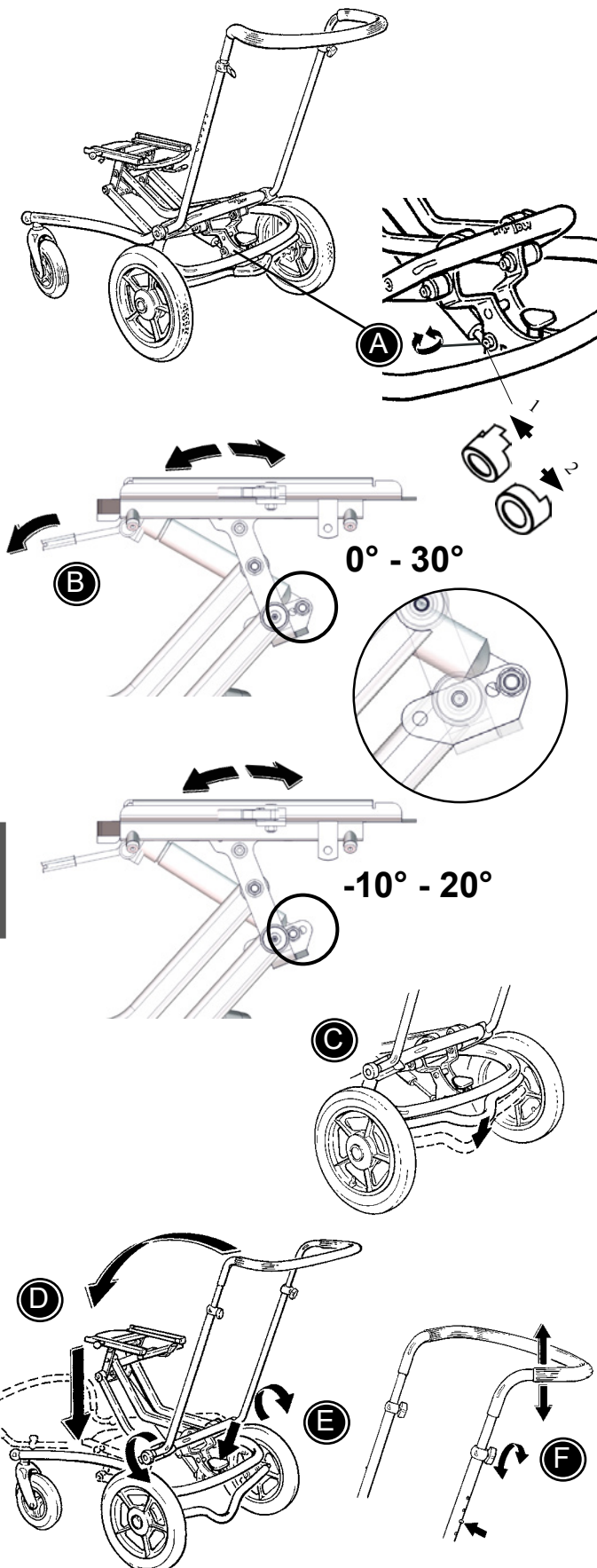

HIGH-LOW:X HYDRAULIC SZ. 2 INDOOR FRAME

The instructions below are for High-low:x hydraulic.

The frame is height adjustable from floor to table height. By stepping on the foot pedal (A) the height is adjusted upwards by using a pumping motion of the foot. The seat is lowered by putting your foot under the foot pedal, lifting up the pedal by which the seat is lowered.

 Be careful when lowering this frame from the highest position to the lowest because of the risk of finger entrapment etc.

 If the the chair has to be used in the lowest position, the foot rest has to be removed first.

The adaptor is angled by lightly pressing down the handle (B) and pushing against the seat back.

 The handle is also equipped with a security knob. This must be deactivated before use.

 It is important to press down on the back while the seat is angled to ensure a slow angling.

Let go of the handle and the seat is “locked” in the wanted position. Activate the security knob.

All four wheels have brakes (C).

The height adjustment can be made both with or without a seat on the frame.

 The High-low:x indoor frame is only for indoor use.

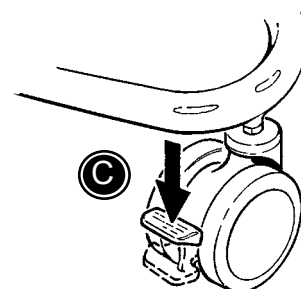
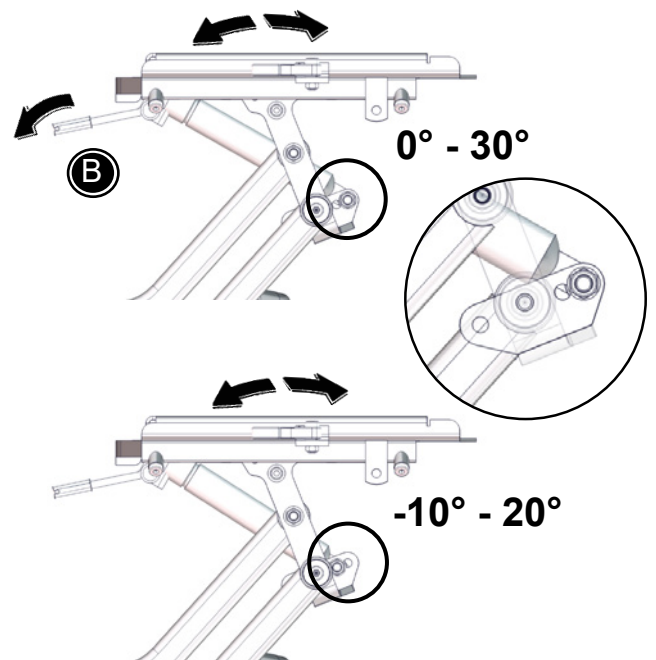
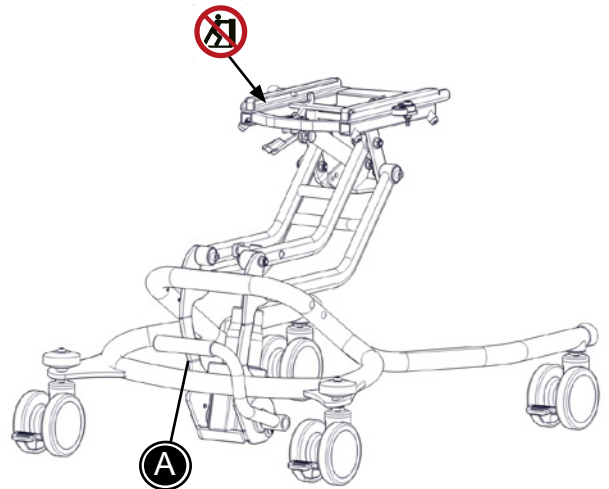

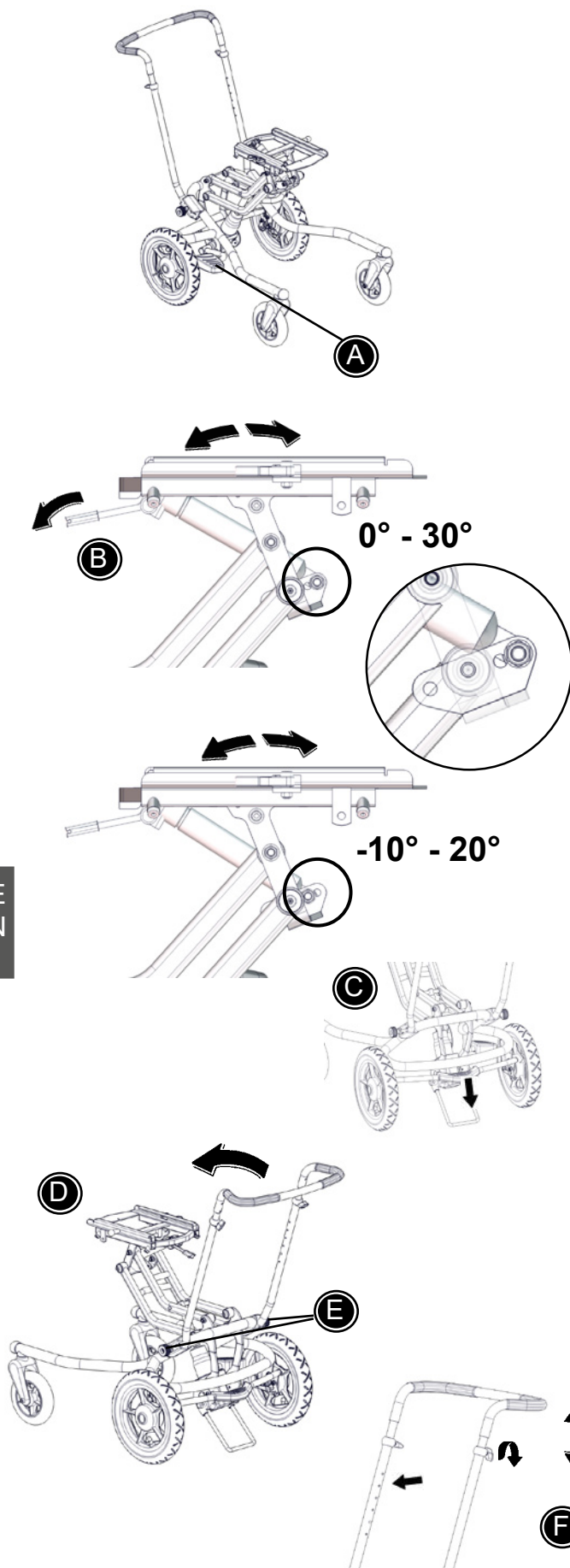

HIGH-LOW:X HYDRAULIC SZ. 2 OUTDOOR FRAME

The instructions below are for High-low:x hydraulic.

The frame is height adjustable from floor to table height. By stepping on the foot pedal (A) the height is adjusted upwards by using a pumping motion of the foot. The seat is lowered by putting your foot under the foot pedal, lifting up the pedal by which the seat is lowered.

! Be careful when lowering this frame from the highest position to the lowest because of the risk of finger entrapment etc.

! If the the chair has to be used in the lowest position, the foot rest has to be removed first.

The seat is angled by lightly pressing down the handle (B) and pushing against the seat back.

! The handle is also equipped with a security knob. This must be deactivated before use.

! It is important to press down on the back while the seat is angled to ensure a slow angling.

Let go of the handle and the seat is "locked" in the wanted position. Activate the security knob.

Activate the brake with the foot (C).

The frame is very easy to fold (D). Lift up the foot pedal (A) and the seat unit can be pushed down to floor height. Then loosen the handles (E) at both sides and fold the handbrace.

The push brace is adjustable in height (F).

! The High-low:x outdoor frame is approved for transportation of children in vehicles.

INDOOR AND OUTDOOR FRAME WITH POWER HIGH-LOW SZ. 1 HIGH-LOW:X SZ. 1+2

The instructions below are for High-low and for High-low:x.

Both the High-low/High-low:x indoor and outdoor frame is available with an actuator. Use the handset (A) to adjust the height of the seat.

 Be careful when lowering this frame from the highest position to the lowest because of the risk of finger entrapment etc.

 If the the chair has to be used in the lowest position, the foot rest has to be removed first.

Follow the description below to recharge the batteries:

- 1) Plug the charging lead into the handset.
- 2) Plug the charger into the electricity supply and switch on, the light on the charger will light up.
- 3) Charge the batteries until the lamp on the charger turns to green.

 For optimum lifetime of the actuator, connect it to the mains voltage 12 hours before use.

To gain the optimal profit of the height adjustment function, the batteries must be recharged every night. The batteries can not be charged to much, but do not ever let them drain completely.

The batteries have a maximum life of 4 years but this can vary depending upon the conditions of use. Only replace batteries with new ones of the same type and manufacture.

 The High-low/High-low:x indoor frame with power is only for indoor use.

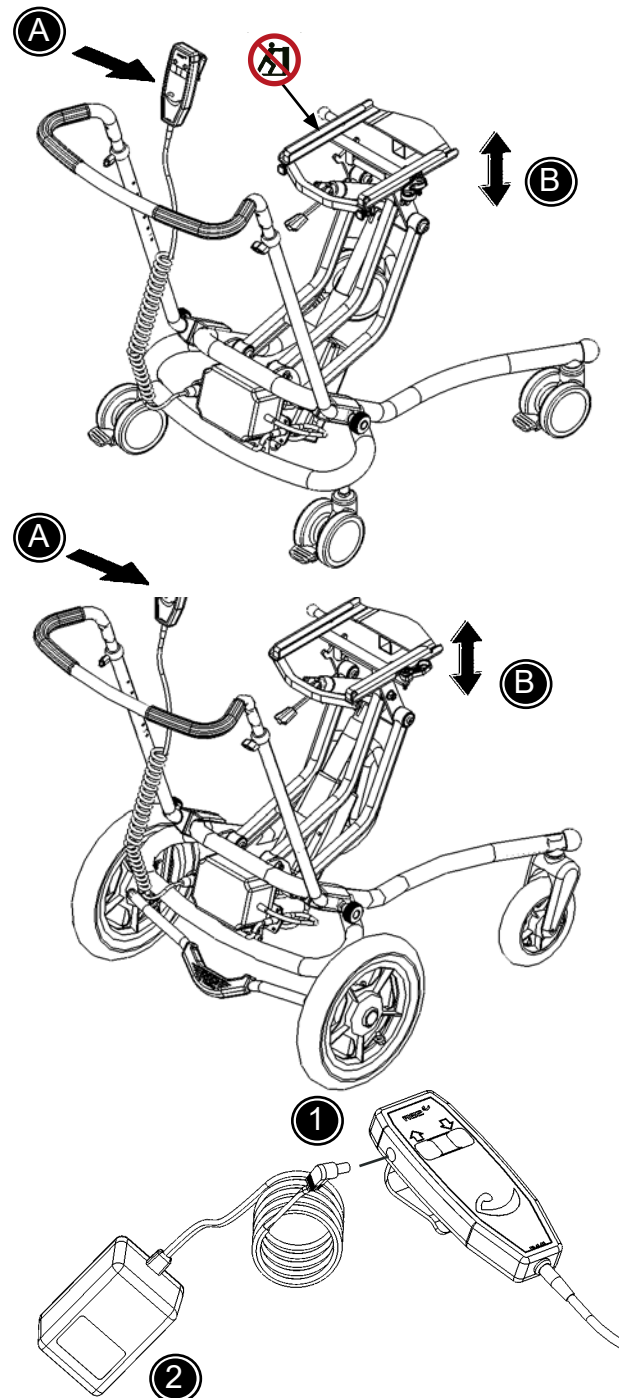

 The High-low/High-low:x outdoor frame is approved for transportation of children in vehicles when used in the approved manner.

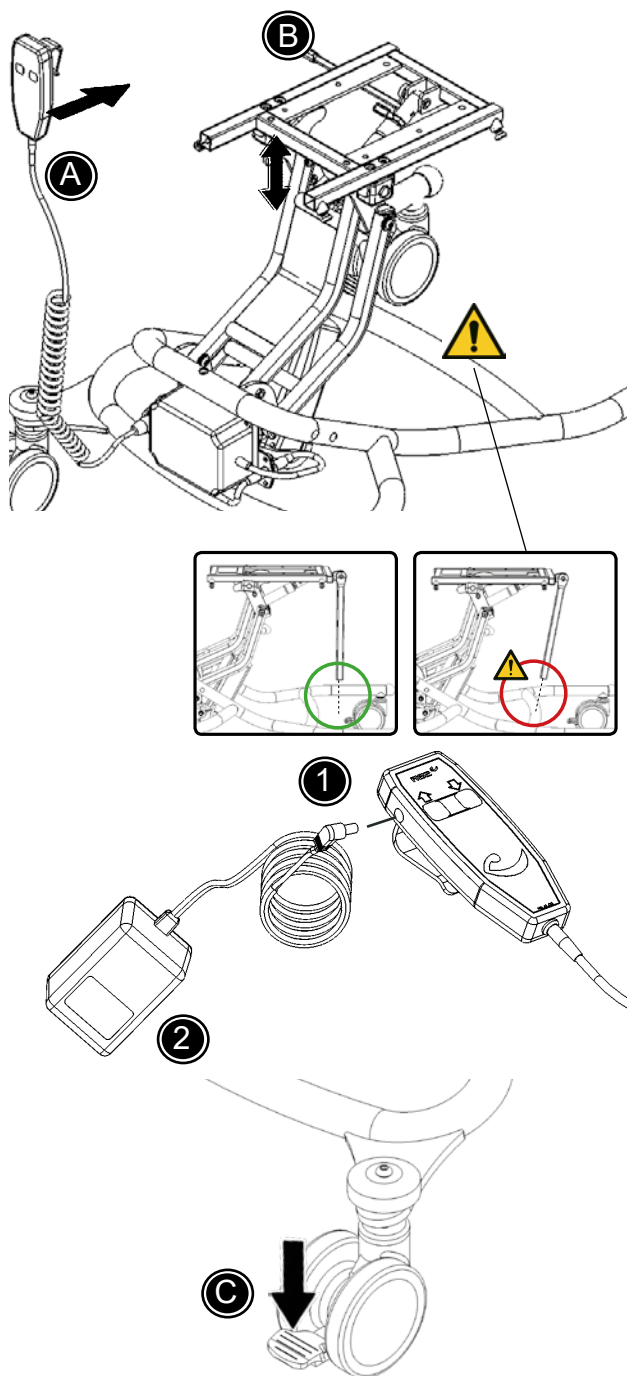



INDOOR FRAME WITH POWER HIGH-LOW:X SZ. 3

The High-low:x indoor frame sz. 3 is only available with an actuator. Use the handset (A) to adjust the height of the seat.

-  Be careful when lowering this frame from the highest position to the lowest because of the risk of finger entrapment etc.
-  If the the chair has to be used in the lowest position, the foot rest has to be removed first.
-  The frame with power does not have a safety stop at the height adjustment function. Please make sure that the foot support bar does not collide with the cross bar on the frame.

Follow the description below to recharge the batteries:

- 1) Plug the charging lead into the handset.
- 2) Plug the charger into the electricity supply and switch on, the light on the charger will light up.
- 3) Charge the batteries untill the lamp on the charger turns off.

-  For optimum lifetime of the actuator, connect it to the mains voltage 12 hours before use.

To gain the optimal profit of the height adjustment function, the batteries must be recharged every night. The batteries can not be charged to much, but do not ever let them drain completely.

The batteries are to be replaced within a period of 4 years and the new batteries must be of the same type and manufacture.

Further, angle the adaptor by lightly pressing down the handle (B) and pushing against the seat back.

-  It is important to press down on the back while the seat is angled to ensure a slow angling.

Let go of the handle and the seat is "locked" in the wanted position.

All four wheels have brakes (C).

The height adjustment can be made both with or without a seat on the frame.

-  The High-low:x indoor frame is only for indoor use.

-  The High-low:x frame is not approved for transportation of children in vehicles.

PUSH BRACE FOR INDOOR FRAME

Depth adjustment: Loosen the screws (A) at both sides of the frame and depth adjust the push brace. The push brace adjusts in two depths and clicks into place with the security pin.

Fasten in the desired position.



Warning 05

Squeezing Hazard between seat and push-brace when adjusting seat angle.



Prohibition: Incorrect lifting points, especially on stairs

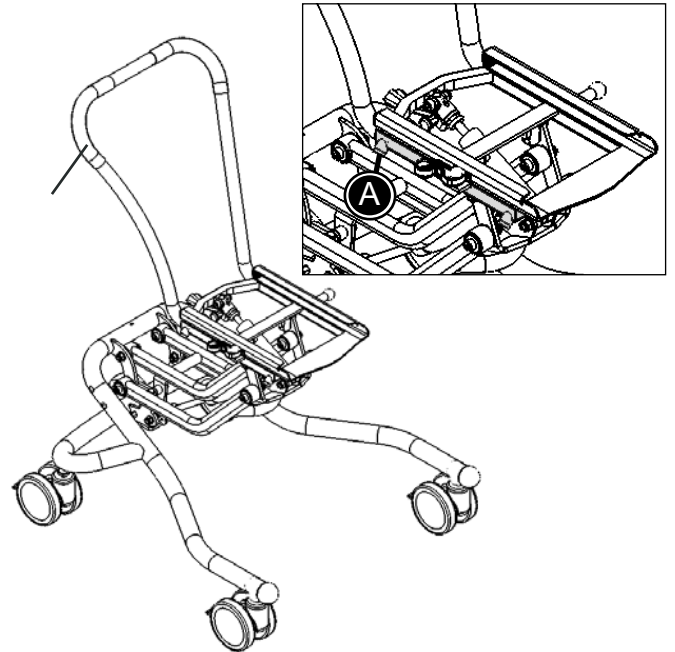

PUSH BRACE FOR OUTDOOR FRAME

Height adjustment: Loosen the handles (A) and push in the locking pin (B).

ADJUSTING THE "WOMBAT" FOOT PLATE

Angle adjustment - foot plate bar:
Loosen the handle (A).

Angle adjustment - foot plate:
Turn the fingerscrew to the right to adjust upwards and to the left to adjust downwards (A).

Height adjustment - foot plate:
Loosen the handle (B) using a 6 mm Allen key.



Do not use the footrest as a step.



Warning 01 Entrapment hazard: When the foot support(s) is in the lowest position the castors can reach it when turning.



Warning 05 Squeezing hazard between frame and footplate when adjusting the angle of the foot support bar C

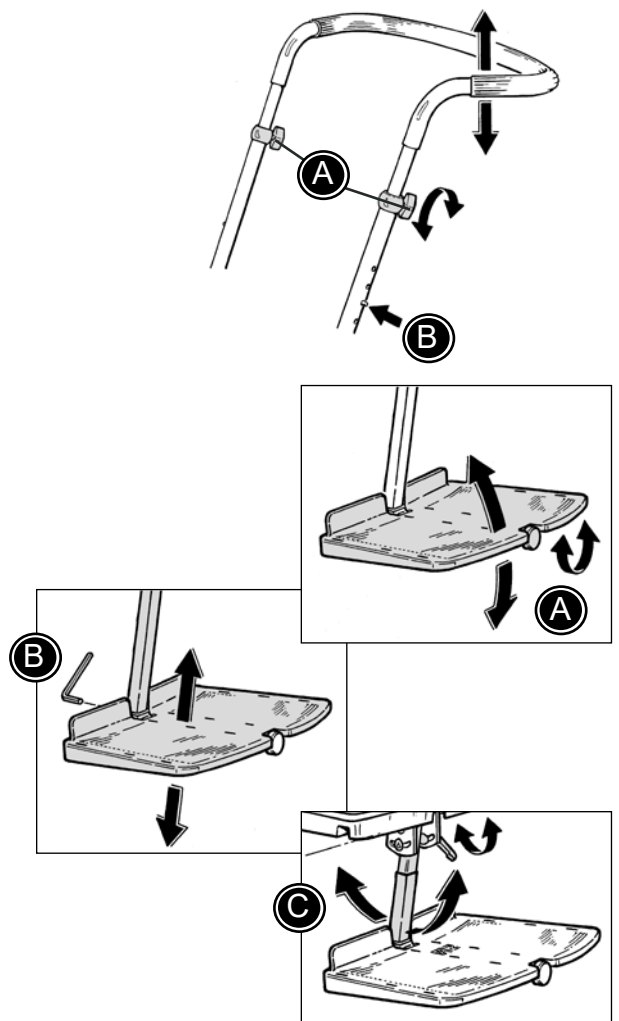

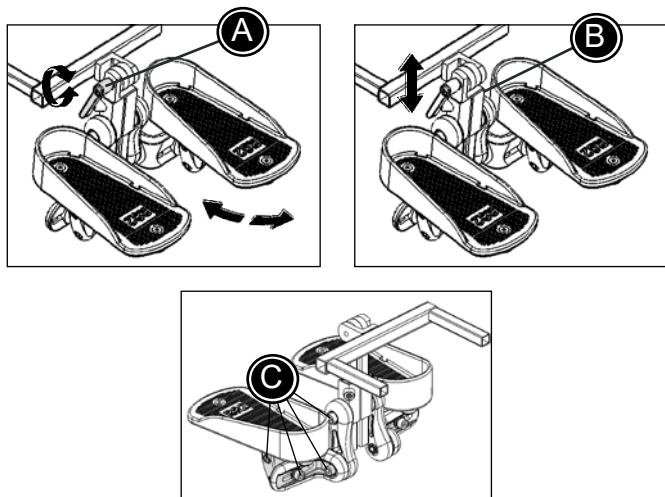

ADJUSTING THE INDIVIDUAL FOOT SUPPORTS

Angle adjustment - foot support bar:
Loosen the handle (A).

Height adjustment - foot support bar:
Loosen the screw (B) using a 6 mm Allen key.

Multi adjustment:
Loosen the screws (C) to angle, width, depth and height adjust the foot support.

 Do not use the footrest as a step.

 Entrapment hazard: When foot supports is in the lowest position the wheels can hit them

INDIVIDUAL FOOT SUPPORTS FOR X:PANDA

Mounting:
Mount the individual footsupports in the interface and tighten the screws (A).

Width adjustment:
Remove the screws (B) using the 5 mm Allen key. Place the footsupport as required and re-mount the screws.

Angle adjustment:
Loosen the screws (C or D) using the 5 mm Allen key, replace screws and tighten.

Height adjustment:
Loosen the screws (E) using the 5 mm Allen key, set the height and tighten.

 Do not use the footsupports as a step.

 Entrapment hazard: When foot supports is in the lowest position the wheels can hit them

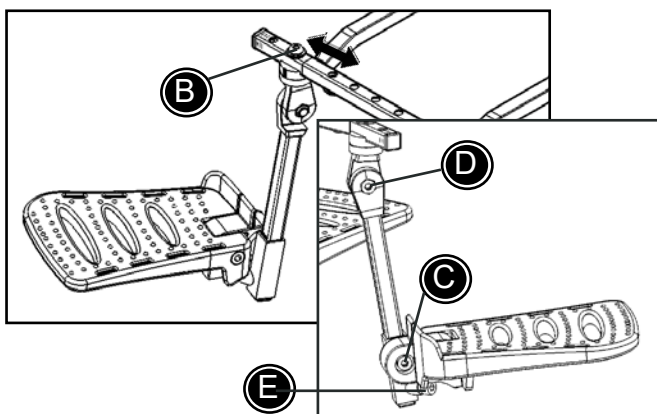
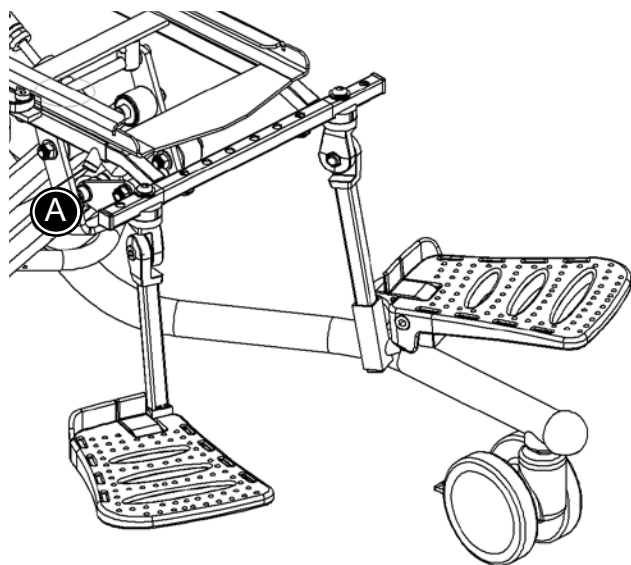

GASSPRING ADJUSTMENT

Some of the frames are equipped with a gas-spring to regulate the angle. After a period the gas-spring might need to be adjusted. The adjustment is only necessary when:

- the gas-spring releases itself
- the gas-spring can not be released at all

If the gas-spring releases itself; loosen the nut (B) with a 17 mm wrench. Then turn the piston rod (A) counter clockwise to tighten. Fasten the nut (B) again.

If the gas-spring can not be released at all; loosen the nut (B) with a 17 mm wrench. Then turn the piston rod (A) clockwise to loosen. Fasten the nut (B) again.

 Do not expose the gas-spring to pressure, high temperatures or perforation.

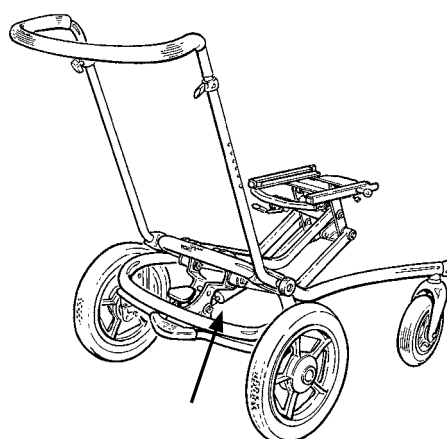
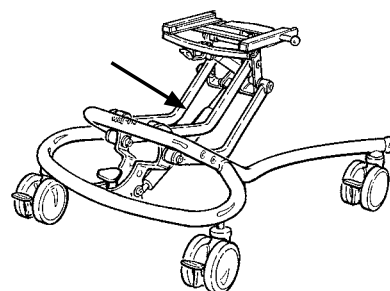
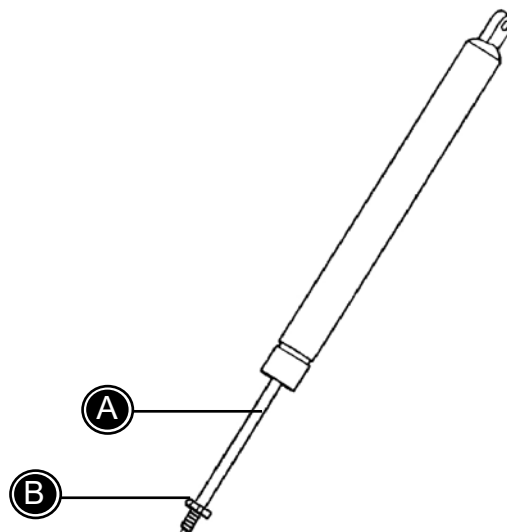

TRANSPORT FITTINGS

Mount the two fittings (A) with the symbol (B) on both sides of the frame.

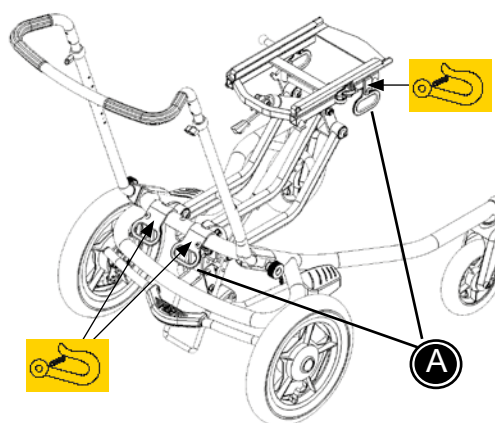
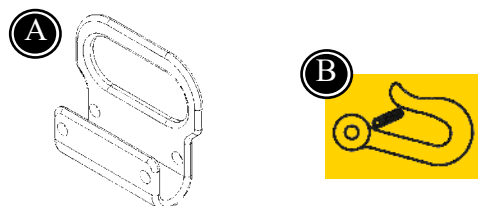

PRODUCT IDENTIFICATION

High-low/High-low:v/High-low:x indoor and outdoor frame

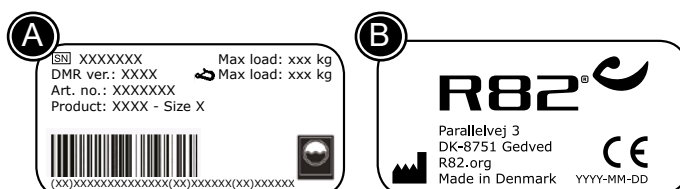

- A) Serial number
The label is placed on the left side of the frame.
- B) Manufacturer
The label is placed on the left side of the frame.
- C) No Pushing - Size 1 and 2 only!
The label is placed on the left side of the frame.

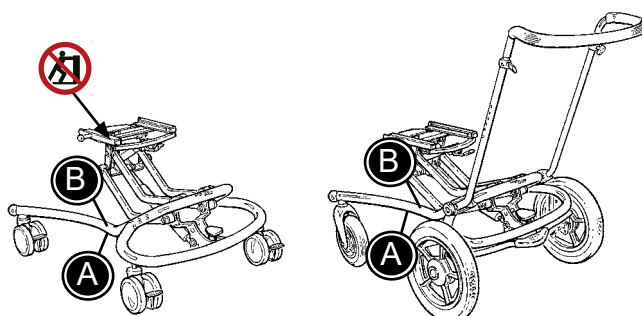



The latest version of the User Guide is always available online: www.R82.org



Declaration of Conformity

This product conforms to the requirements of the Medical Devices Directive (93/42/EEC). The CE mark must be removed when rebuilding the product, when used in combination with a product from another manufacturer or when using other than original R82 spare parts and fittings. Further, this product conforms to the requirements according to:

Indoor frames: EN 12182

Outdoor frames: EN 12182 and EN 12183

Enclosed tools:

- 4,5 and 6 mm Allen key
- 10 and 13 mm spanner

R82 Warranty

R82 offers a 2-year warranty against defects in workmanship and materials and a 5-year warranty on breakage of the metal frame caused by defects in welds. The warranty would be adversely affected if the customer's responsibility of servicing and/or maintenance is not carried out according to the guidelines and intervals prescribed by the supplier and/or stated in the User Guide. For further information, we refer to the R82 homepage/download.

The warranty is only granted in the country where the product was purchased and if the product can be identified by the serial number. The warranty does not cover accidental damage, including damage caused by misuse or neglect. The warranty does not extend to consumable items e.g. tires or upholstery, which are subject to normal wear and tear and need periodic replacement.

The warranty is null and void if other than original parts/accessories are used, or if the product has not been maintained, repaired or altered according to the guidelines and intervals prescribed by the supplier and/or stated in the User Guide. R82 reserves the right to inspect the product being claimed for and the relevant documentation before agreeing to the warranty claim, and to decide upon whether to replace or repair the defective product. It is the customer's responsibility to return the item being claimed for under warranty to the address of purchase.



Safety

- Signs, symbols and instructions placed on this product must never be covered or removed and must remain present and clearly legible throughout the entire lifetime of the product. Immediately replace or repair illegible or damaged signs, symbols and instructions. Contact your local dealer for instructions
- Information about transportation can be found in the document "Transportation in Motor Vehicles" supplied with the product
- Information about roadability can be found in the document "Roadability" supplied with the product
- Information regarding frame and seat combinations including max. load in combination can be found at: support.r82.org

Caregiver

- Read the "User Guide" carefully before use and keep it for future reference. Incorrect use of this product may cause serious injury to the user
- Always use the correct lifting techniques and aids for this purpose
- Never leave the user unattended in this product. Ensure permanent supervision by an adult
- Repair/replacements must only be made using new original R82 spare parts and fittings and carried out in accordance with the guidelines and service intervals prescribed by the supplier
- If there is any doubt as to the continued safe use of your R82 product or if any parts should fail, stop using the product immediately and contact your local dealer as soon as possible
- Always use the product in a moderate pace. Do not run with the product
- Always check the brakes before use

Environment

- Observe the surface temperature on the product, before placing an user in it. This goes especially for users with insensitive skin as they can not feel the heat. If the surface temperature is above 41°C then allow the product to cool before use
- Use this product on a level surface without any obstacles. Be aware of reduced maneuverability on slippery roads
- When using on inclines, please refer to measurements

User

- If the user is close to the max. load limit and/or has a lot of involuntary movements, e.g. rocking, a larger size with a higher max. load or a different R82 product should be considered
- For transportation the product is suitable for children in the weight range of 22 kg to specified max user weight for transportation.
- Do not place more than one user in the product.

Product

- Carry out all positional adjustments on the product and accessories and ensure that all knobs, screws and buckles are securely fastened before use. Keep all tools out of the reach of children
- Ensure the stability of the product is maintained before placing the user in it
- Inspect the product and all of its accessories and replace any worn out parts before use
- Do not expose the piston rod to scratches etc. It is important to use a cloth or the like, if tools are used to adjust the gas spring
- Deactivate the anti-tips when forcing kerbs higher than 100 mm
- Before storage: Always deactivate wheel locks/brakes

Service information

Maintenance of a medical device is wholly the responsibility of the owner of that device. Failure to maintain a device in accordance with the instructions may invalidate the device's warranty. Furthermore, failure to maintain a device may compromise the clinical condition or safety of users and/or their caregivers.

Daily

- Use a dry cloth to clean the product
- Visual inspection. Repair or replace any damaged or worn-out parts
- Ensure that all fasteners are in place and fitted correctly
- Check all fittings and buckles for signs of worn out parts
- Be aware of any MAX mark indications before adjustment
- Check that all cables connecting the power system are in good shape

Weekly

- Check that all castors are moving freely and that all wheel locks/brakes are easily activated
- Wipe off any residue and dirt from the product using a cloth wrung in warm water and a mild detergent/soap without chlorine and dry before use
- Disinfect the product. please check the disinfection section in this User Guide for more information

Monthly

- All nuts and bolt on this product must be checked and tightened to avoid unnecessary failures
- Oil the swing-away parts. We recommend you use a professional lubricant system

Annually

- Inspect the product for cracks or signs for worn-out parts and carry out annual service. Never use a product which appears to be substandard or faulty

Warewashing machine

This product can be washed at 60° using a mild detergent in 15-20 minutes in a washing machine designed for medical devices. Use the machine's drying function to dry the product. Clean the accessories and any seat separately.

Before washing remove the following items and clean them separately:

- Accessories
- Power unit including; Actuator, battery and handset

After washing:

- Replace the power column
- Check that the handset functionalities works correct

Disinfection

The product can be disinfected with a 70% disinfectant solution. It is recommended to wipe off any residue and dirt from the product, using a cloth wrung in warm water and a mild detergent/soap without chlorine and let it dry before disinfection.

Accessories and spare parts

The products from R82 can be supplied with a variety of accessories which comply with the needs of the individual user. Spare parts can be ordered on request. Find the specific accessories on our website or contact your local dealer for further information.

Service interval

A detailed inspection of the product must be made every 12 months (every 6 months for heavy users) and every time the product is reissued for use. The inspection should be carried out by a technically competent person who has been trained in the use of the product.

The lifetime of this product in normal use is 5 years if all maintenance and servicing is carried out in accordance with the manufacturer's instructions and demonstrably recorded.

Service Check List:

Check and adjust the following functions as per their intended use. Repair or replace any damaged or worn-out parts. Please check the:

- Products equipped with a hydraulic pump for height adjustment. Frame height can be adjusted up and down and the security lock for the frame height works
- Products equipped with power for height adjustment. The cables are in good condition and the handset functionalities for height adjustment works as intended.
- Powered versions are able to retain power after charging the battery
- Pushbrace for outdoor versions is adjustable in height and can be folded over the frame
- Tire pressure
- Gas-spring for seat tilt is adjusted correctly and is possible to lock the seat plane in position
- Castors are moving freely and all wheel locks/brakes are easily activated
- Nuts and bolts on the product are tightened
- Product for cracks or signs for worn-out parts
- All labels on the product are intact

Air pressure

The carer should check and refill the tyres for air at least once a month. Air pressure:

High-low outdoor frame:

- Front: 35 PSI/250 kPa
- Rear: 40 PSI/2,5 bar

Presales information

- Support.r82.org

Power unit

For an optimum lifetime the power unit must be connected to the mains voltages as often as possible (e.g. every night). Charge the batteries 12 hours before use.

The batteries must be charged at least every 3rd month - otherwise there might be damages due to self-discharge. It is recommended to test the battery function at least once every year.

Recharging the battery:

- Plug the charging lead into the handset
- Plug the charger into the electricity supply and switch ON. A yellow light on the charger will light up
- Charge the batteries until the lamp on the charger turns green

Caregiver

- Do not leave children and youngsters alone with the handset
- Do not let children and youngsters play with the handset
- Do not leave the handset within reach of children and youngsters it is important to remove the transport plastic bag before using the handset. Cables need to be placed in such a way that users or carers cannot trip and injure themselves.

Product

- The power unit does not have a safety stop
- The system must not be sprayed directly with a highpressure cleaner
- Cleaning with a steam cleaner is not permitted
- Do only use the power unit within specified working limits
- It is recommended to check the handset and cable for damage and holes caused by violent handling at least once a year
- Do not submerge the handset in water
- Do not attempt to repair any part of the power unit.

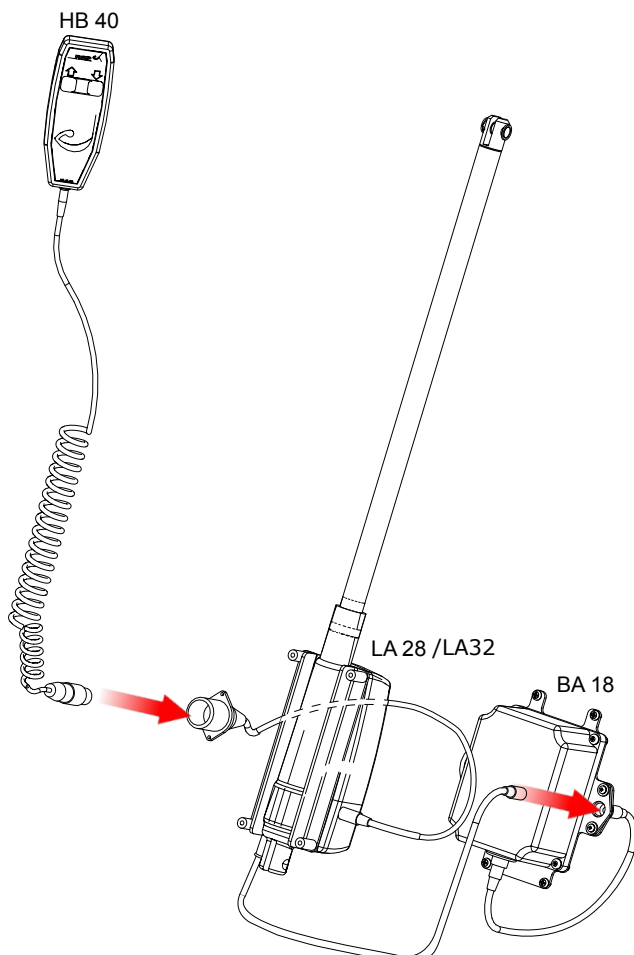

Technical Data

Battery - BA18

- Capacity 1.3 Ah - 24V DC
- Charging current max. 500 mA
- IPX6
- Duty cycle: Max. 10% or 2 min. use then 18 min. without use

The batteries have a maximum life of 4 years but this can vary depending upon the conditions of use and charging practices

Battery charger - CH01

- Mains: 100 - 240VAC/50-60 Hz switch mode
- Charging voltage: 27.6 VDC
- Charging current: Max. 500 mA

Actuator - LA28 or LA32

- Input voltage: 24V
- Noise level: ≤ 45 dB(A)
- IPX5

Handset - HB 40

- IPX1

Detachable parts

- Handset - HB 40
- Battery - BA 18

Applied part

- Handset - HB 40

IP-Rating table

IPX0	No protection
IPX1	Protection against vertically falling drops of water e.g. condensation
IPX2	Protection against direct sprays of water up to 15° from the vertical
IPX3	Protected against direct sprays of water up to 60° from the vertical
IPX4	Protection against water sprayed from all directions - limited ingress permitted
IPX5	Protected against low pressure jets of water from all directions - limited ingress
IPX6	Protected against temporary flooding of water, e.g. for use on ship decks - limited ingress permitted
IPX7	Protected against the effect of immersion between 15 cm and 1 m
IPX8	Protects against long periods of immersion under pressure

Environmental conditions

- Operating temperature: 5°C to 40°C
- Storage temperature: -10°C til +50°C
- Relative humidity: 20% to 90%
- Atmospheric pressure: 800 to 1060 hPa

Disposal



When a product reaches the end of its lifetime, it should be separated by material type so that the parts can be recycled or disposed of properly. If required, please contact your local dealer for a precise description of each material. Please contact your local authorities to be informed of the options available for recycling in an environmentally-friendly way.

Electromagnetic compatibility (EMC) environment

This equipment is for use in home healthcare facility environment.

This equipment is not likely to cause any harmful interference in nearby equipment; however, it can be impaired by electromagnetic (EM) interference emitted by other equipment, which can lead to malfunctions. Do not use this equipment where there is a risk that other electrical and/or electronic equipment can interfere with this equipment.

This equipment complies with the following standards

IEC 60601-1-2:2014 Medical electrical equipment - Part 1-2: General requirements for basic safety and essential performance - Collateral Standard: Electromagnetic disturbances - Requirements and tests (EN 60601-1-2:2015)

EN 12182:2012, Clause 7, Assistive products for persons with disability – General requirements and test methods

EMC - WARNINGS

Use of this equipment adjacent to or stacked with other equipment should be avoided because it could result in improper operation. If such use is necessary, this equipment and the other equipment should be observed to verify that they are operating normally.

Use of accessories, transducers and cables other than those specified or provided by R82 could result in increased EM emission or decreased EM immunity of this equipment and result in improper operation. Several power plugs are supplied with this equipment. Please use the correct power plug suitable for your country. Please choose among the supplied power plug adaptor units: English, Australian, EU, US/Japanese plugs.

Portable radio frequency (RF) communication equipment (including peripherals such as antenna cables and external antennas) should be used no closer than 30 cm (12 inches) to any part of the product, including cables specified by R82. Otherwise, degradation of the performance of this equipment could result.

EN

Testing for EM disturbances (EM emission and EM immunity)

Test modes during emission tests:

1. Movement mode (battery). Actuator running in/out
2. Charging mode, actuator not running.

EM emission standards	Classification/levels
Conducted and radiated RF emission CISPR 11	Group 1 (the product uses RF energy only for its internal function) Class B (the product is suitable for use in all establishments, including domestic establishments and those directly connected to the public low-voltage power supply network that supplies buildings used for domestic purposes)
Harmonic distortion IEC 61000-3-2	Class A. No testing performed, as the rated power for this equipment is less than 75 W. No limits are specified for equipment with a rated power of 75 W or less.
Voltage fluctuations and flicker IEC 61000-3-3	$d_{max} \leq 4\%$ (without additional conditions)

Test modes during immunity tests:

Battery mode, standby armed/ready.

Charging mode, actuator not running.

EM immunity standards	IEC 60601-1-2:2014 test levels	Additional test levels
Electrostatic discharge IEC61000-4-2	± 8 kV contact ± 2 kV, ± 4 kV, ± 8 kV, ± 15 kV air	± 6 kV contact
Radiated RF EM fields IEC 61000-4-3	10 V/m 80 MHz – 2.7 GHz 80 % AM at 1 kHz	20 V/m 800 MHz – 2.5 GHz 80 % AM at 1 kHz
Proximity fields form RF wireless communication equipment IEC 61000-4-3	IEC 60601-1-2:2014 Table 9	N/A
Electrical fast transients / bursts IEC 61000-4-4	± 1 kV, ±2 kV 100 kHz repetition frequency	± 1 kV, ± 2 kV 5 kHz repetition frequency
Surges, Line-to-line IEC 61000-4-5	± 0,5 kV, ± 1 kV 230 VAC	± 0,5 kV, ± 1 kV 100 VAC and 240 VAC
Conducted disturbance induced by RF fields IEC 61000-4-6	6 Vrms 0.15 MHz – 80 MHz 80% AM at 1 kHz	N/A
Rated power frequency magnetic fields IEC 61000-4-8	30 A/m 50 Hz	30 A/m 50 Hz and 60 Hz
Voltage dips, short interruptions and voltage variations IEC 61000-4-11	0 % U_T for 0,5 cycle at 0°, 45°, 90°, 135°, 180°, 225°, 270° and 315° phase angles 0 % U_T for 1 cycle 70 % U_T for 25 cycles 0 % U_T for 250 cycles 230 VAC	0 % U_T for 1 cycle 40 % U_T for 10 cycles 70 % U_T for 25 cycles 100 VAC and 240 VAC
Variation of power frequency IEC 61000-4-28	N/A	49 Hz and 51 Hz 100 VAC and 240 VAC, 50 Hz 59 Hz and 61 Hz 100 VAC and 240 VAC, 60 Hz

Symbols



For indoor use



For indoor and outdoor use



Consult instructions

The latest version of the instructions is always available on the R82 website and can be printed in larger sizes



Warning

This symbol appears in the User Guide along with a number referring to the instructions below. It draws attention to situations where the product or the user or carer's safety may be in danger

01 = Entrapment Hazards

02 = Tilting Hazards

03 = Transportation in motor vehicles

05 = Squeezing Hazard



Prohibition

Incorrect lifting points, especially on stairs



Prohibition

No pushing



Correct lifting point

MEASURES

Frame	Length (mm)	Width (mm)	Height floor to interface (mm)	Seat angle	Weight (kg)	Max load (kg)	Max load at trans- portation (kg)
High-low indoor frame	690	560	170-600	+40°	12,3	60	-
High-low indoor frame w/power	690	560	170-600	+40°	12,8	60	-
High-low:x indoor frame, sz. 1	690	560	170-600	+40°	12,5	60	-
High-low:x indoor frame, sz. 2	780	620	250-610	+40°	14,0	60	-
High-low:x indoor frame, sz. 1 w/power	690	560	170-600	+40°	13,0	60	-
High-low:x indoor frame, sz. 2 w/power	780	620	250-620	+40°	16,5	60	-
High-low:x indoor frame, sz. 3 w/power	780	620	260-550	+40°	17,0	100	-
High-low:x indoor frame, sz. 2 w/hydraulik	780	620	220-580	+40°	16,5	60	-
High-low outdoor frame	960	620	260-700	+40°	17,5	60	43*
High-low outdoor frame w/power	960	620	260-700	+40°	18,0	60	43*
High-low:x outdoor frame, sz. 1	960	620	260-700	+40°	17,5	60	43*
High-low:x outdoor frame, sz. 2	1110	620	330-640	+40°	20,0	60	43*
High-low:x outdoor frame, sz. 1 w/power	960	620	260-700	+40°	18,0	60	43*
High-low:x outdoor frame, sz. 2 w/ power	1110	620	330-640	+40°	20,5	60	43*
High-low:x outdoor frame, sz. 2 w/hydraulik	1110	620	430-590	+40°	20,5	60	43*

Frame	Footrest to adap- tor plate
-------	-----------------------------------

High-low indoor frame	50 - 290
High-low indoor frame w/power	50 - 290
High-low:x indoor frame, sz. 1	50 - 290
High-low:x indoor frame, sz. 2	50 - 290
High-low:x indoor frame, sz. 1 w/power	50 - 290
High-low:x indoor frame, sz. 2 w/power	50 - 290
High-low:x indoor frame, sz. 3 w/power	50 - 290
High-low:x indoor frame, sz. 2 w/hydraulik	50 - 290
High-low outdoor frame	50 - 290
High-low outdoor frame w/power	50 - 290
High-low:x outdoor frame, sz. 1	50 - 290
High-low:x outdoor frame, sz. 2	50 - 290
High-low:x outdoor frame, sz. 1 w/power	50 - 290
High-low:x outdoor frame, sz. 2 w/ power	50 - 290
High-low:x outdoor frame, sz. 2 w/hydraulik	50 - 290



* Further information regarding max. load/user weight at transportation:
http://www.r82.org/media/102124/frame_and_seat_combination.pdf

TECHNICAL DATA

Frame: Powderpainted steel

PRODUCER

R82 A/S
 Parallevej 3
 8751 Gedved

DISTRIBUTOR



Please find your distributor on R82.org

LIFTING AND TRANSFER

Always use the correct lifting techniques for this purpose

