

Etac Cart II

User manual (EN)

molift[®]
by Etac

BM15501 Rev B 2021-09-10



English Manual

Content

General.....2
 CE declaration.....2
 Conditions for Use.....2
 Warranty.....2
 Etac Cart II.....3
 Nomad version components.....3
 About Nomad version.....3
 HoverTech version components.....4
 About HoverTech version.....4
 Technical Data.....5
 Product identification.....5
 Assembly.....6-8
 Assembly parts.....6
 Cup and arm holder Nomad version.....6
 Cup holder HoverTech version.....7
 Measuring templates.....7
 Permanent mounted basket (optional).....8
 Checklist after assembly.....8
 How to use Etac Cart II.....9
 Connecting Nomad to rail
 with extension arm.....9
 HoverTech version.....10
 Accessories.....11
 Battery charger.....11

Extension arm..... 11
 Maintenance..... 12
 Cleaning and disinfection..... 12
 Recycling..... 12
 Spare Parts..... 12
 Troubleshooting..... 13

Important

This User Manual contains important safety instructions and information regarding the use of this product and accessories.



Warning!
 This symbol indicates important information related to safety. Follow these instructions carefully.



Read User Manual before use!
 It is important to fully understand the content of the user manual before attempting to use the equipment.

Visit www.etac.com for download of documentation to ensure you have the latest version.

General



CE declaration
 The product, and its related accessories, described in this instruction for use (IFU), is in compliance with the regulation (EU) 2017/745 of 5. April 2017 – as a medical device, risk class I.
 Any serious incident that occurs in relation to the device should be reported to the manufacturer and the competent authority of the Member State in which the user and/or patient is established.

Conditions for Use

Only for transportation of Molift Nomad lifter, HoverTech fan and accessories. Only trained personnel are allowed to use the equipment and accessories mentioned in this user manual.

Modifications and use of components made by other manufacturers.

We recommend only using Etac Molift components and spare parts. Etac is not responsible for warranty if any modifications are made to the product. Etac shall not be liable for faults or accidents that can occur when using components made by other manufacturers.



Only certified personnel are allowed to perform service or repair.

Warranty notice
 Two-year warranty against defects in workmanship and materials of our products.
 Please refer to www.etac.com for terms and conditions.

Etac Cart II (Nomad version)

Cart components:

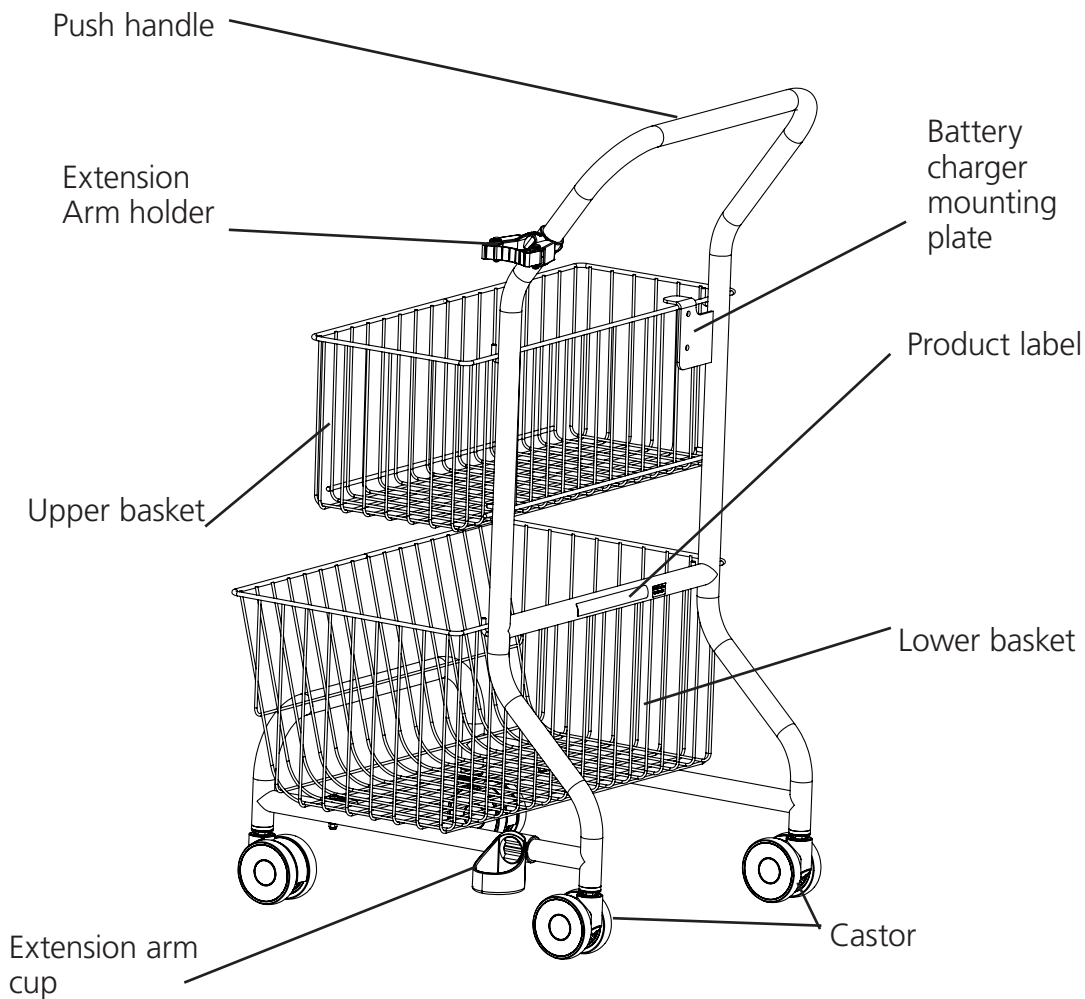

Etac Cart II (Nomad version)

Etac Cart II (Nomad version) is an accessory for the transportable Molift Nomad ceiling hoist. The Cart is intended for storing, transportation and charging (optional) of the Molift Nomad ceiling hoist. The cart is made of steel, has 4 castors, 2 baskets for storing of Nomad ceiling hoist and slings. It also has an holder for Nomad Extension arm (accessory).

It is ideal for hospital and institutional care settings but can also be used in private homes.

Etac Cart II (HoverTech version)

Cart components:

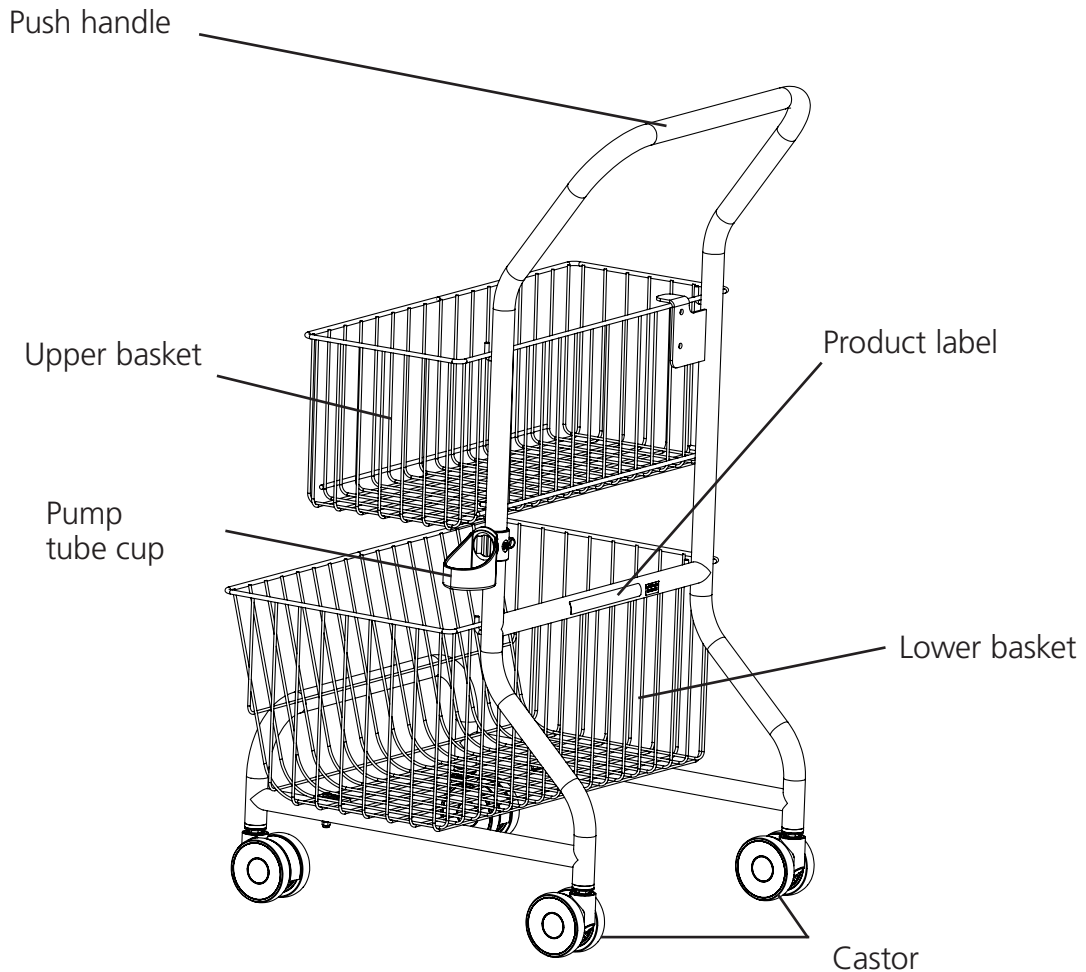

Etac Cart II (HoverTech version)

Etac Cart II (HoverTech version) is an accessory for the transportable HoverTech pump. The Cart is intended for storing and transportation.

The cart is made of steel, has 4 castors, 2 baskets for storing of HoverTech pump and accesories.

It is ideal for hospital and institutional care settings but can also be used in privates homes.

Technical Data

Nomad version

Dimensions (Width, Length, Height):

559 x 485 x 975 mm

Weight of unit:

8,2 kg/ 18 lbs

Material:

Steel, Plastic

Turning diameter:

100 cm (39.4 inches)

Max load:

Upper basket: 10 kg (22 lbs)

Lower basket: 25 kg (55 lbs)

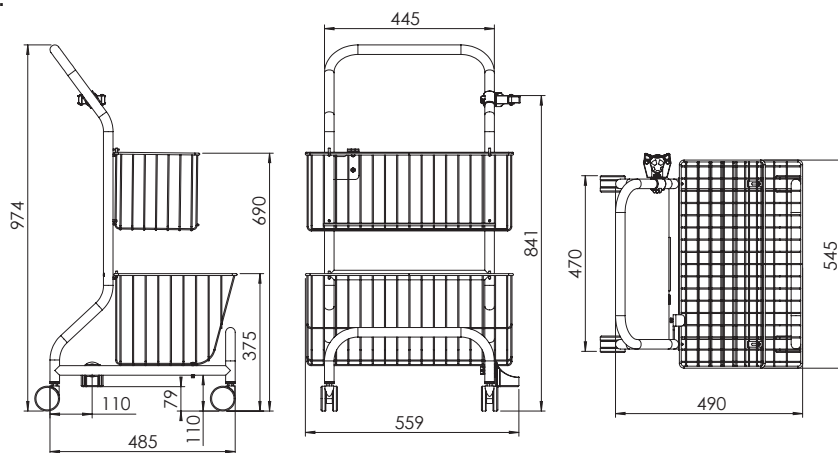

HoverTech version

Dimensions (Width, Length, Height):

545 x 485 x 975 mm

Weight of unit:

8,2 kg/ 18 lbs

Material:

Steel, Plastic

Turning diameter:

100 cm (39.4 inches)

Max load:

Upper basket: 10 kg (22 lbs)

Lower basket: 25 kg (55 lbs)

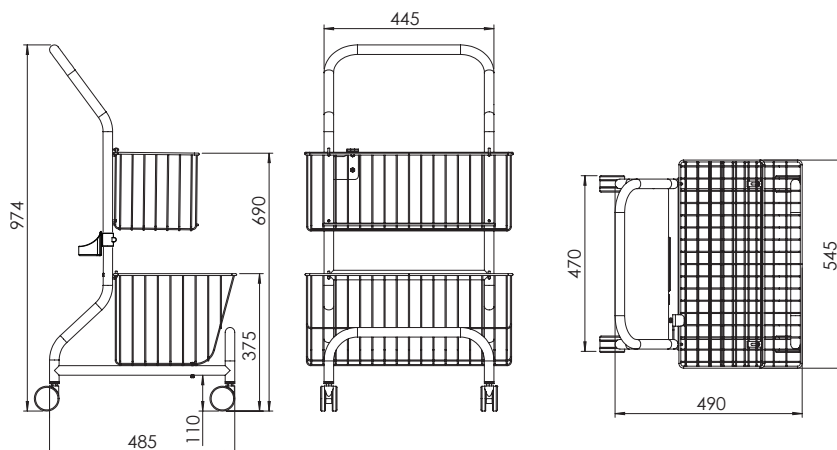

Product identification





Product label

The Product labels barcode contain article number and EAN code

Warning labels and Symbols

Symbols used on the product, explained in more detail:



-  Manufacturer
-  Date of manufacture
-  Catalogue number
-  Serial number
-  Medical Device

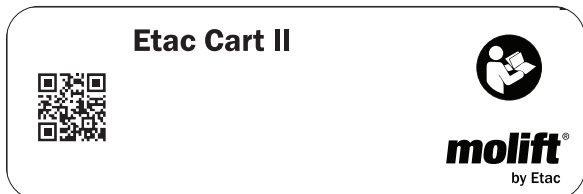

Assembly

Assembly parts

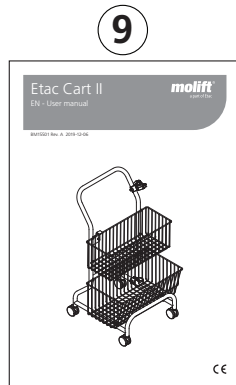
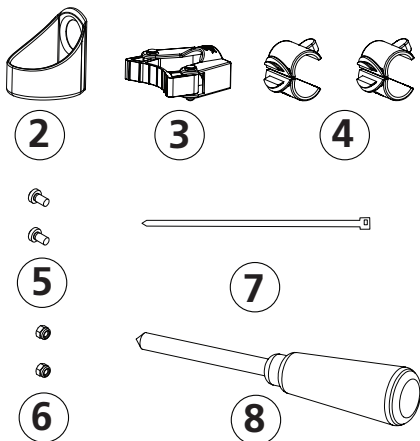
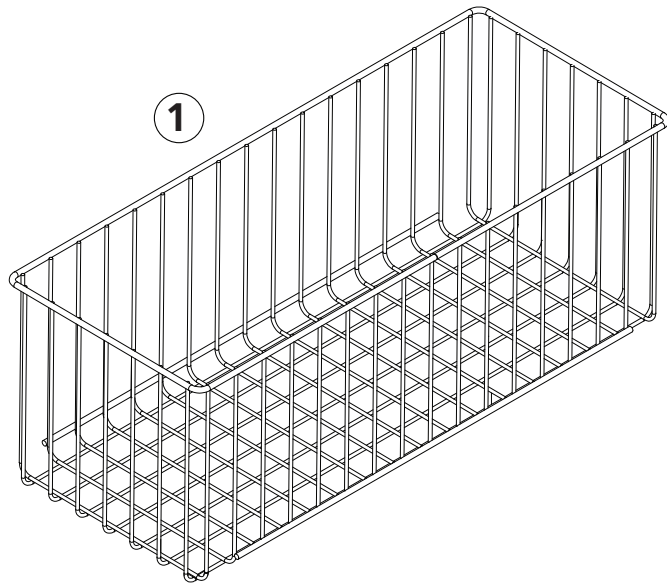

1. Upper basket
2. Toolflex cup
3. Toolflex holder
4. Toolflex tube mount (2x)
5. M6x16 screw (2x)
6. M6 nylock nut (2x)
7. Strips
8. Screw driver Ph2
9. User manual

Cup and arm holder (Nomad version)

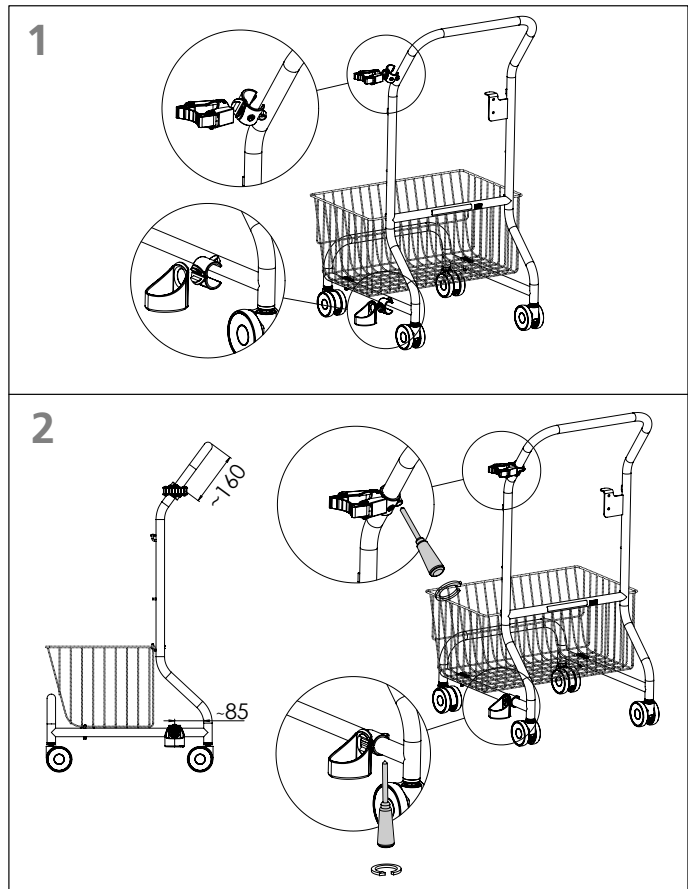

1. Open up the tube clamp. Insert the cup holder/arm holder together with the clamp. Close the clamp around the tube. The cup/arm holder will now connect to the clamp.
2. Use templates on page 7 for positioning of cup and arm holder. 160mm for arm holder and 85mm for cup holder.
3. Use the applied phillip screw driver and tighten the screws for the pipe clamp.

Cup holder (HoverTech version)

Measuring templates

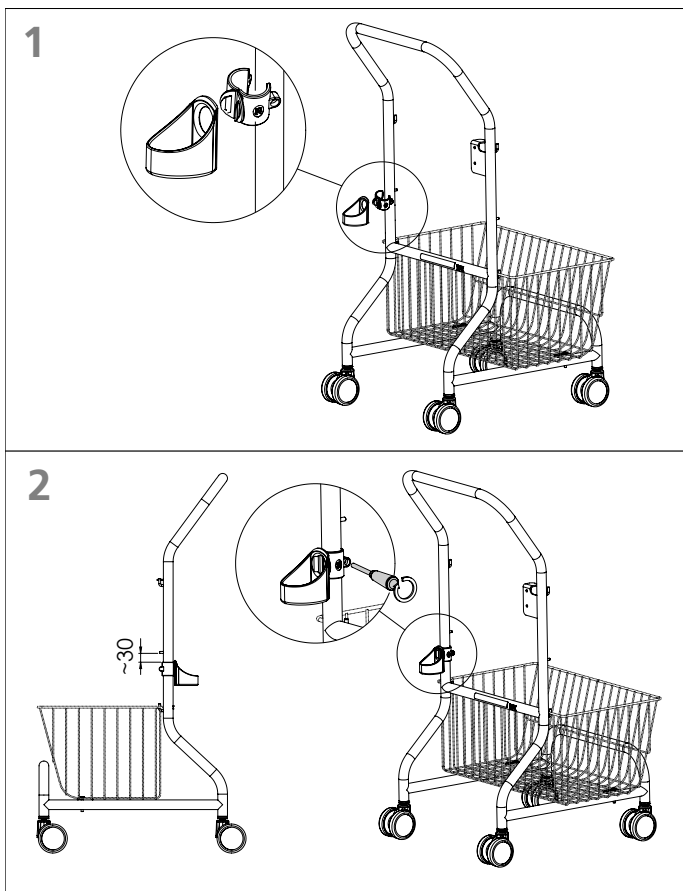

1. Open up the tube clamp. Insert the cup holder together with the clamp. Close the clamp around the tube . The cup will now connect to the clamp.
2. Use template 30 mm on page 7 for positioning of cup holder.
3. Use the applied phillip screw driver and tighten the screws for the pipe clamp



Basket

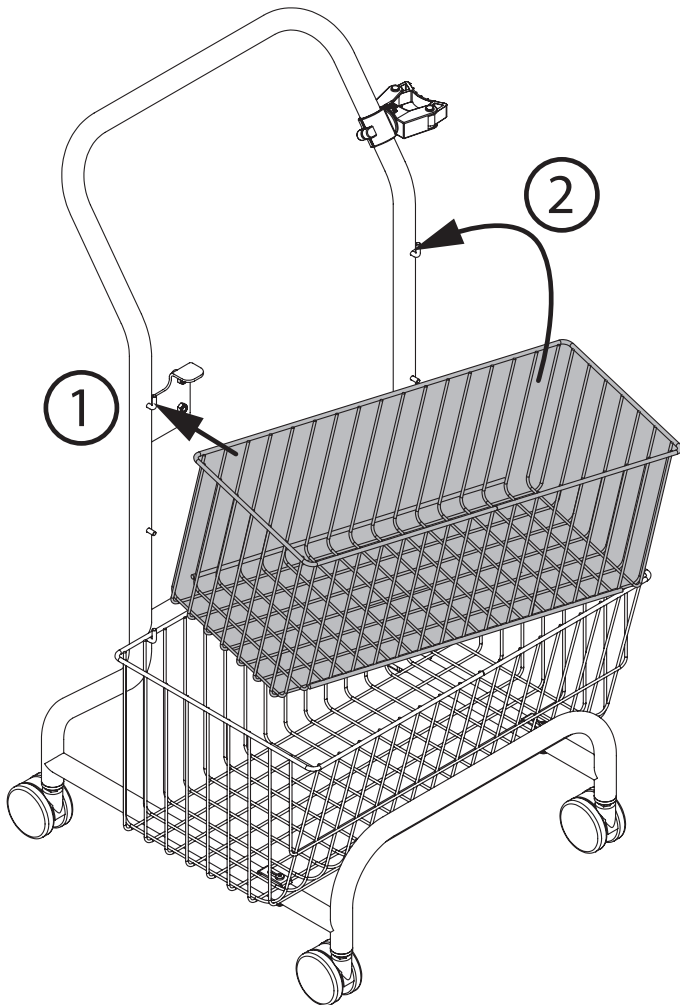

Stand in front of the Nomad Cart and attach the upper basket first on the left side hook (1) and thereafter on the right side hook (2).

Fixed basket (optional)

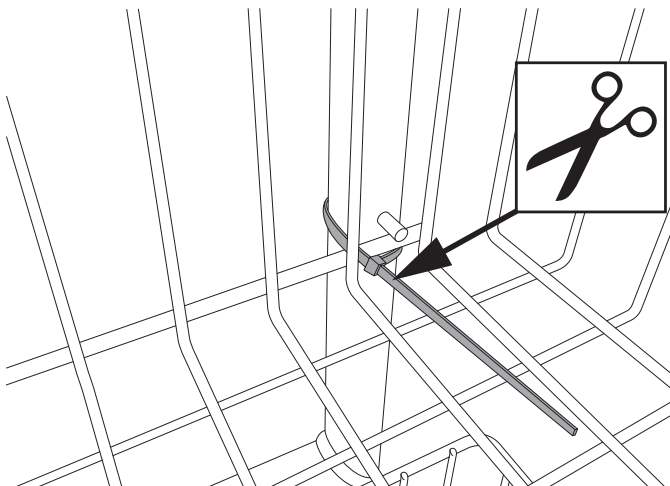

Upper basket can be permanently mounted with the cable tie. Fasten around basket and frame on right side. Cut away excess of cable tie.

Checklist after assembly



Do not start using cart before completing control according to checklist after assembly.

Use this checklist to verify that the Nomad cart is properly assembled and can operate correctly and safely before use.

- Make sure basket is properly fastened
- Make sure cart feels steady and all 4 wheels rolls freely. The cart should move in a straight line and not steer away in any direction when pushed on an even floor.

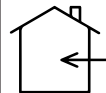

The cart is intended for indoor use only.

How to use Etac Cart II

Nomad version

Connecting Nomad to rail with extension arm

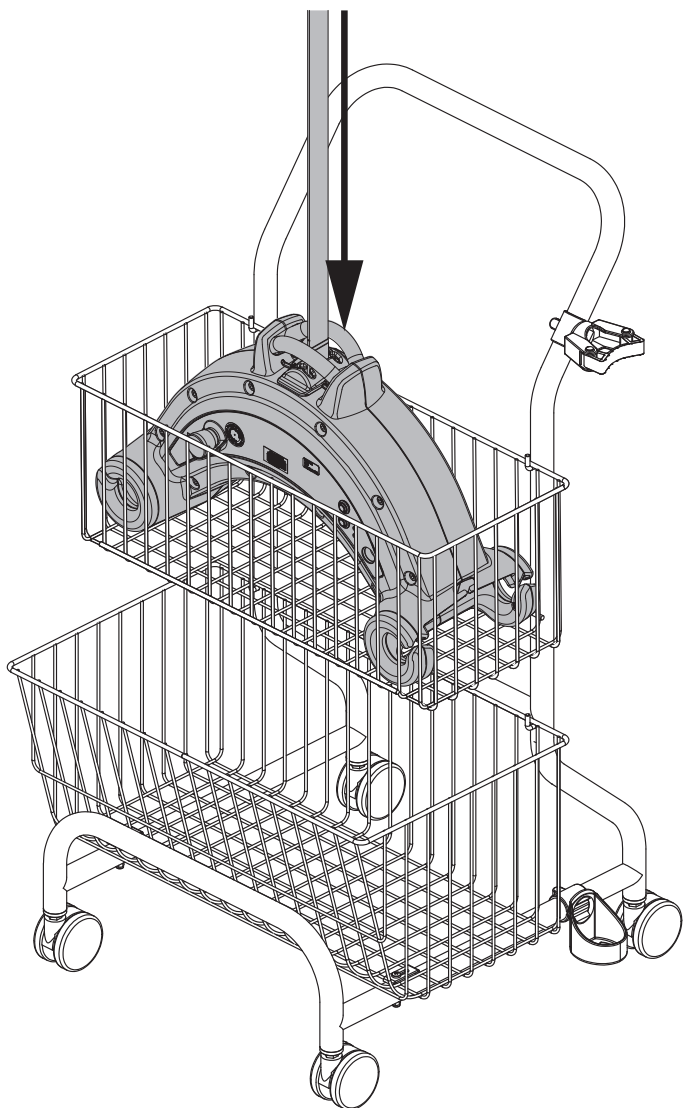

Nomad ceiling hoist fits in the upper basket. Lower basket can be used for storing slings.



Place Nomad ceiling hoist in upper basket. Push down button on hand control to drive out lifting strap. Use extension arm (accessory) to connect lifting strap to trolley in rail.

HoverTech version

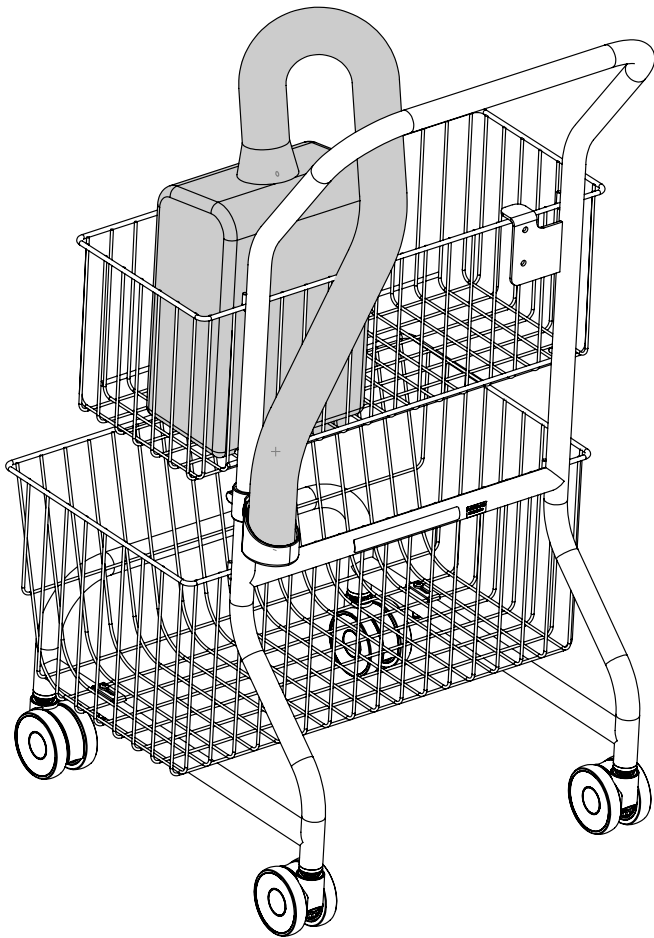

HoverTech pump fits in the upper basket. Insert the end of the tube into the cup holder.



Stand behind and push the cart with push handle.

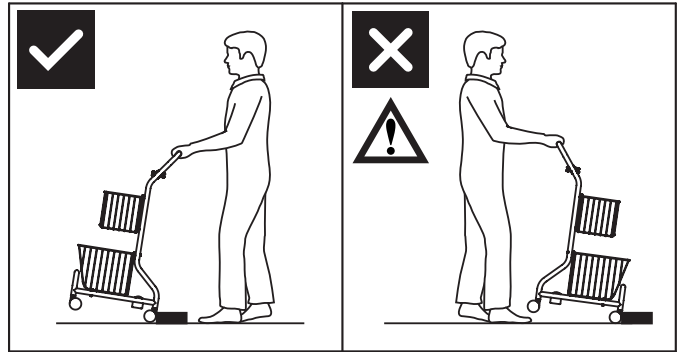
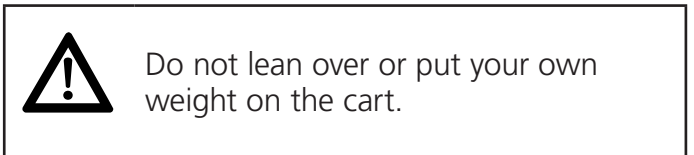

Pull the cart over thresholds or other obstacles.



Accessories

Recommended optional equipment and accessories for Etac Cart II.

Battery charger

Nomad ceiling hoist is charged through the hand control. The hand control charger can be mounted on the Nomad Cart. Use the screws and nuts supplied with the Nomad Cart and mount on the battery charger mounting plate.

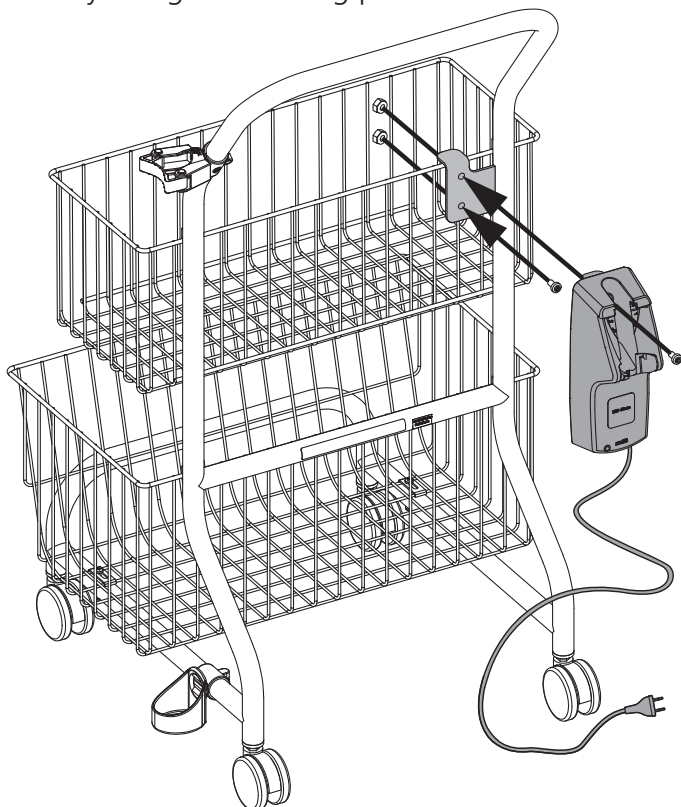

Charger for handcontrol Molift Nomad/AIR.
Art. no.: 1240100

Extension arm

Molift Extension Arm is made for safe and easy mounting of Molift Nomad to the trolley in a rail system. The Nomad Cart has a holder for the extension arm. The extension arm is available in 2 different lengths.



Molift Extension Arm 900 mm
Art. no.: 1200004
Molift Extension Arm 1050 mm
Art. no.: 1200006

Maintenance

Cleaning and disinfection

Clean on a regular basis. Clean surfaces with a damp cloth using an appropriate pH-neutral detergent. Do not use solvents or strong liquids, this may damage surfaces on the lifter. For disinfection when needed; use isopropyl alcohol. Avoid abrasive cleaning products. Remove hair and pile from the castors and verify that the castors rotates freely.



Make sure not to damage or remove labels when cleaning.

Recycling

Etac Cart II can be disposed of as metal waste without battery charger. Battery charger must be removed and disposed of as Electrical equipment.

Spare Parts

Wheel Ø65

Art. no.: 0920107

Extension arm holder parts

Toolflex holder (top)

Art. no.: 1220200

Toolflex tube mount (part around tube)

Art. no.: 1220201

Toolflex cup (bottom)

Art. no.: 1220202

Troubleshooting

| Symptom | Possible Cause/Action |
|--|--|
| The nomad cart moves unevenly on a plane surface | The castors move unevenly because of pile and dust. Clean the castors. Remove hair and dirt. |
| | Castors may be loose Check castors and make sure they are properly fastened. Tighten properly with 13mm wrench. |



Etac A/S
Parallevej 3
DK-8751 Gedved
www.etac.com

molift[®]
by Etac