

Raiser Pro

EN - Recycling Instructions

molift[®]
by Etac

RI43001 Rev A. 2022-09-30

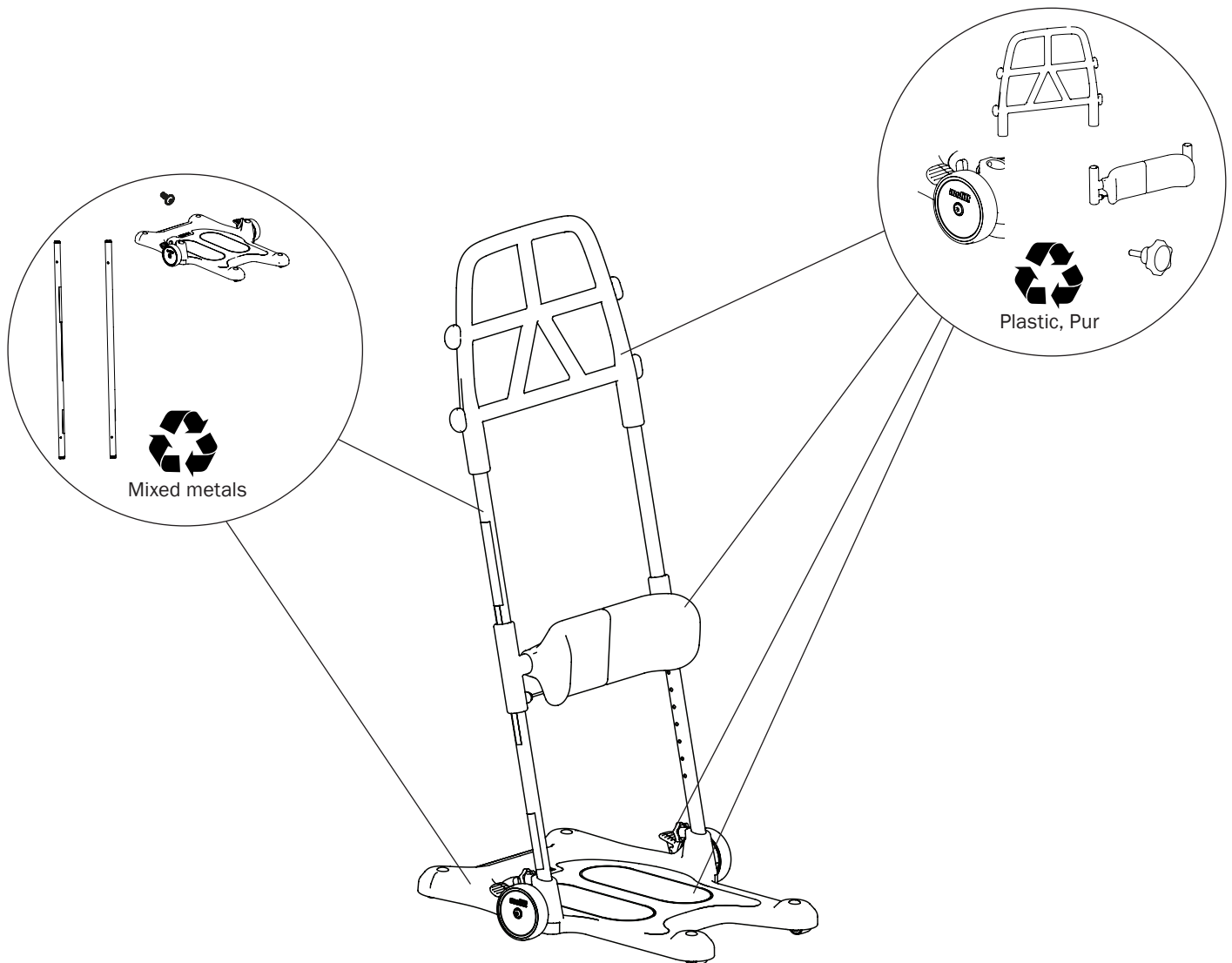

Etac A/S
Parallevej 3
DK-8751 Gedved
www.etac.com

Wheels, are made of recyclable plastics (e.g. polypropylen and rubber) and can be removed from the main plate and recycled seperately. Bearings should be recycled as mixed metals.

Screws and steel rod inside the knee support should be recycled with mixed metals. The foot plate is made out of plastic and should be recycled with knee support, turning knobs and wheels.