

Account No. _____ Drop Ship: _____
 Date: _____ Name _____
 P.O. Number: _____ Address _____
 Buyer: _____ City _____
 Marked For: _____ State _____ Zip _____
 E Mail: _____ Tel. _____ Fax _____

Measurements

	Penguin	
	cm (inch)	
Length (L)	80 (31")	
Width (W)	33 (13")	
Height (H)	26 (10")	
Length, abduction block to top	56-72 (22-28")	
Inside width, tightest place (IW)	16 (6½")	
Frame height (I)	94-115 (36¾-44¾)	
Frame width (G)	55 (21½)	
Frame length (H)	111 (43¼)	
Bath tub height, inside (I1)	29 (11¼)	
Bath tub width, inside, bottom (G1)	40 (15½)	
Bath tub width, inside, top (G2)	47 (18¼)	
Bath tub length, inside, bottom (H1)	86 (33½)	
Bath tub length, inside, top (H2)	103 (40¼)	
Weight, total	16 kg (35.5 lb)	
Max. user weight	50 kg (110 lb)	

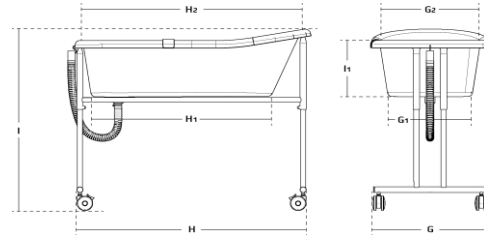
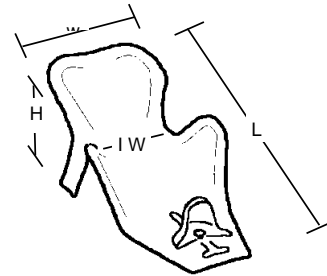

Penguin

Penguin lying support*	87702	795 <input type="checkbox"/>
<i>*Fits in Orca bathtub</i>		

Orca

Orca bathtub on height adjust frame	87550	2,225 <input type="checkbox"/>
--	--------------	---------------------------------------

Orca Accessories

Flamingo Bath Seat	880101	725 <input type="checkbox"/>
Flamingo Bath Seat	880102	725 <input type="checkbox"/>
Suction cups for Flamingo Seat	880150	105 <input type="checkbox"/>
Extension hose for Orca	111555	65 <input type="checkbox"/>