

Molift Air

205/300

molift[®]
by Etac

Periodic inspection checklist

In accordance with ISO:10535

PI16101 Rev E 2021-12-13

Components

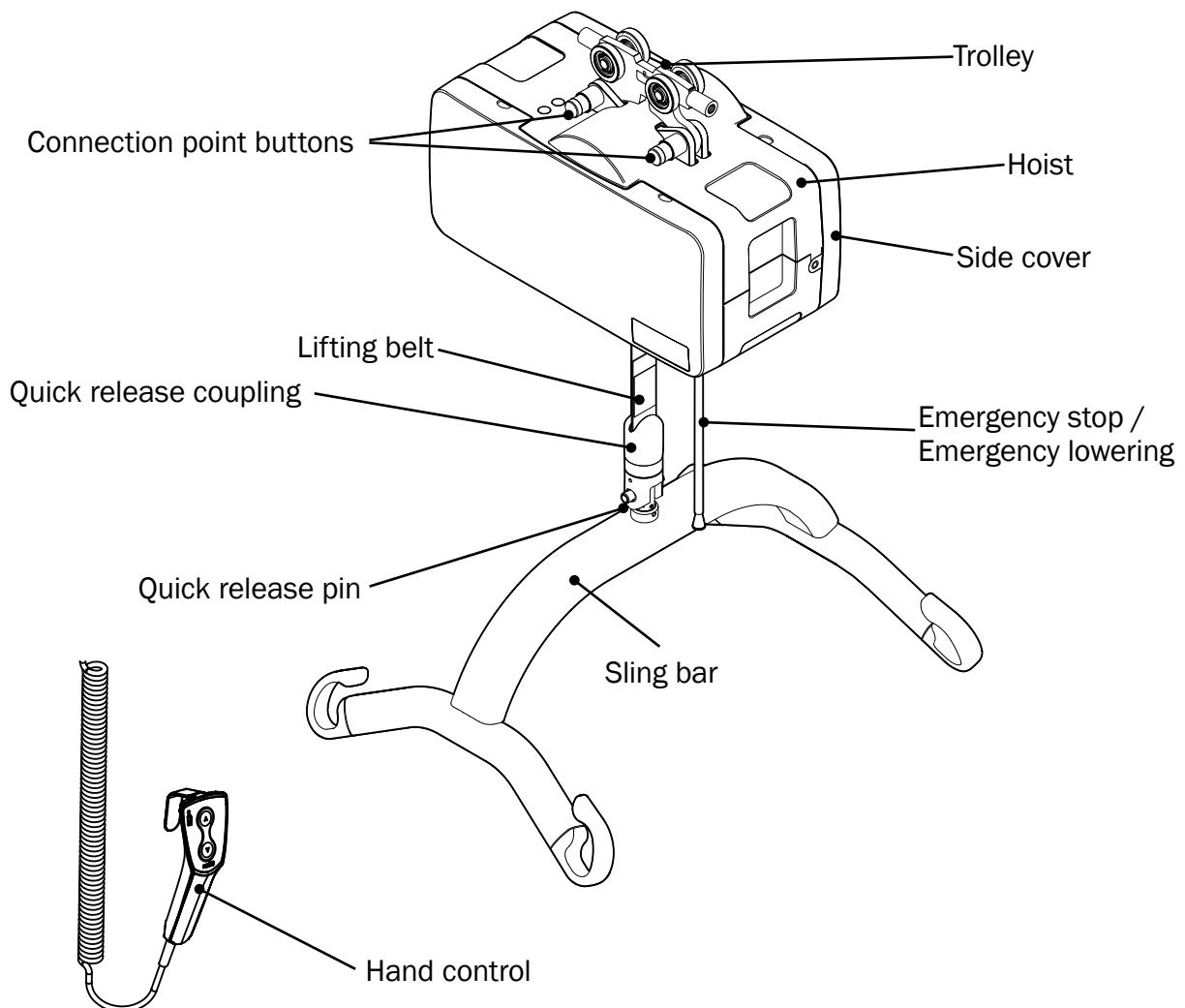

Product label

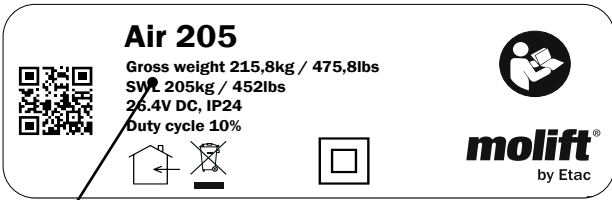

SWL value

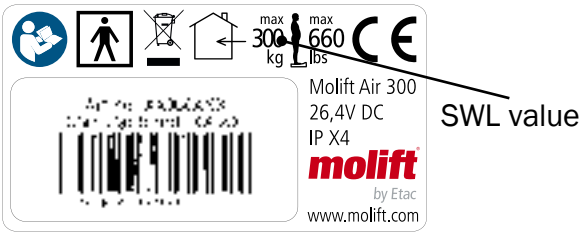
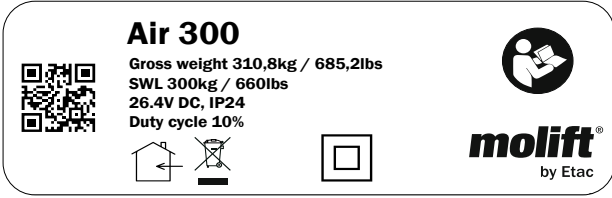

SWL value

ID label



Serial no. Article no. Production date

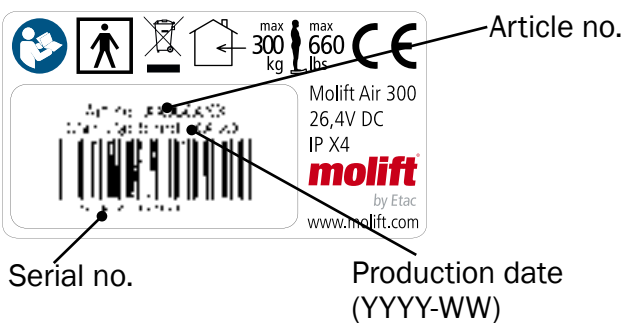

Serial no. Production date (YYYY-WW)

A copy of this document is available for download at www.etac.com.

Scan QR code on product label for accessing product home page. The user manual can be found in the document section.

Article no. (see ID label):

.....

Serial no. (see ID label):

.....

Production Year:

.....

Owner:

.....

Sling shall be inspected separately and is not included in this inspection.

Specify model:

- Molift Air 205
- Molift Air 300

Service light indicator

Note colour of service light indicator:

Status	Service light	Mode
	(No light)	Power saving (Stand by)
	Green	Ready for use
	Yellow	Order service
	Red	Perform service
	Red (and sound when activated)	Perform service immediately

Situation of use

- Home
- Hospital
- Nursing home
- Other

 **The periodic inspection is to be performed by a person who is suitable and properly qualified and well acquainted with the design, use and care of the hoist**

 **The hoist's software Molift Service tool provides option to enter date of PI and name of inspector along with additional information. Molift recommends adding all observations / remarks concerning the hoist in the Molift Service tool for complete history log of the hoist**

Visual examination

	<p>Visual examination of load bearing structure to make sure there is no damage, cracks, frays or deformation. All checkpoints must be checked to approve hoist for further use</p>
-----------------------------------------------------------------------------------	--------------------------------------------------------------------------------------------------------------------------------------------------------------------------------------------

<i>OK</i> <i>Not OK</i>
Lifting belt Must be replaced every 5 years. See lable on belt.
Product labels
Plastic covers
Hand control
Cables
Other electronics
Sling bar
Sling bar hooks
Quick release coupling
Instruction for use / user manual is present / available

Functional examination

	<p>Test FUNCTION and inspect for wear and damage. All checkpoints must be checked to approve hoist for further use</p>
-----------------------------------------------------------------------------------	-------------------------------------------------------------------------------------------------------------------------------

<i>OK</i> <i>Not OK</i>
Emergency stop button is fully operational and interrupts power when engaged. Reset switch. Service light indicator must turn green.
Electrical emergency lowering
Check tools for emergency lowering (found behind covers)
Hand control (buttons, wire sockets, and battery indicator)
Hand control functionality
Quick release coupling (swivel joint moves freely when turned 360° and without noise)
Quick release pin
Connection point buttons
Angle sensor. Pull lifting belt sideways in all four directions
Checked that the hoist functions correctly and runs without load all the way up and down without abnormal noise
End stops
If all points so far are "OK", hoist shall be tested with SWL. NOTE! : Ensure SWL for the complete hoist system exceeds or equals hoist SWL before any load testing
Perform one lifting cycle with weight equal to SWL with min. range of 500 mm in the top of lifting range. Brake must not slip when loaded. Movement must be smooth and even, and without unusual noise
Move hoist loaded with SWL through entire rail system. Check deflection and suspension is acceptable

OK Not OK

Perform new visual control;
 Damage and deformations as described above. Any damaged parts must be repaired or replaced and test is repeated once more until the hoist performs correctly

Charger is operational

Battery.
 Battery light is OFF and service light indicator is green

Accessories (e.g. scale, propulsion, IRC):

.....

.....

Performed by

Full name:

.....

Date/Place:

.....

Signature:

.....

Approved without faults

Next inspection (YYYY / MM):/.....

Hoist is marked with "Out of order" and sent for repair

Hoist is not eligible for repair and taken out of service

If periodic inspection reveals any defect, wear or other damage that jeopardises the safety of the patient the hoist may not be used until the deficiency has been eliminated.

The owner is notified



Due to legal requirements this document or a copy must be filed with the owner's service log book

If approved without faults, apply inspection label on cover inside and mark with month and year of **next** inspection. When ordering label, use item no. 1100306

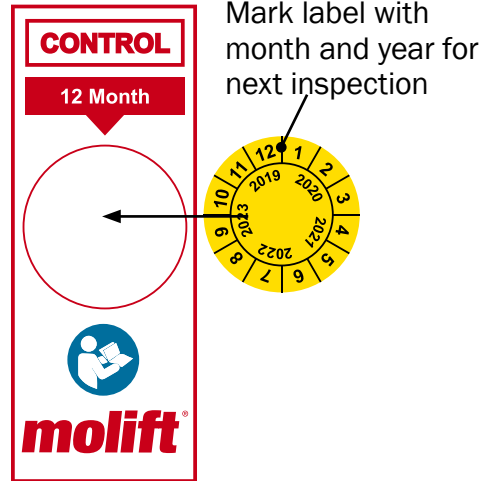

Mark label with month and year for next inspection

Notes and observations

.....