

Molift Quick Raiser 205

molift[®]
by Etac

Periodic inspection checklist (EN)

In accordance with ISO:10535

PI13001 Rev. C 2022-06-16

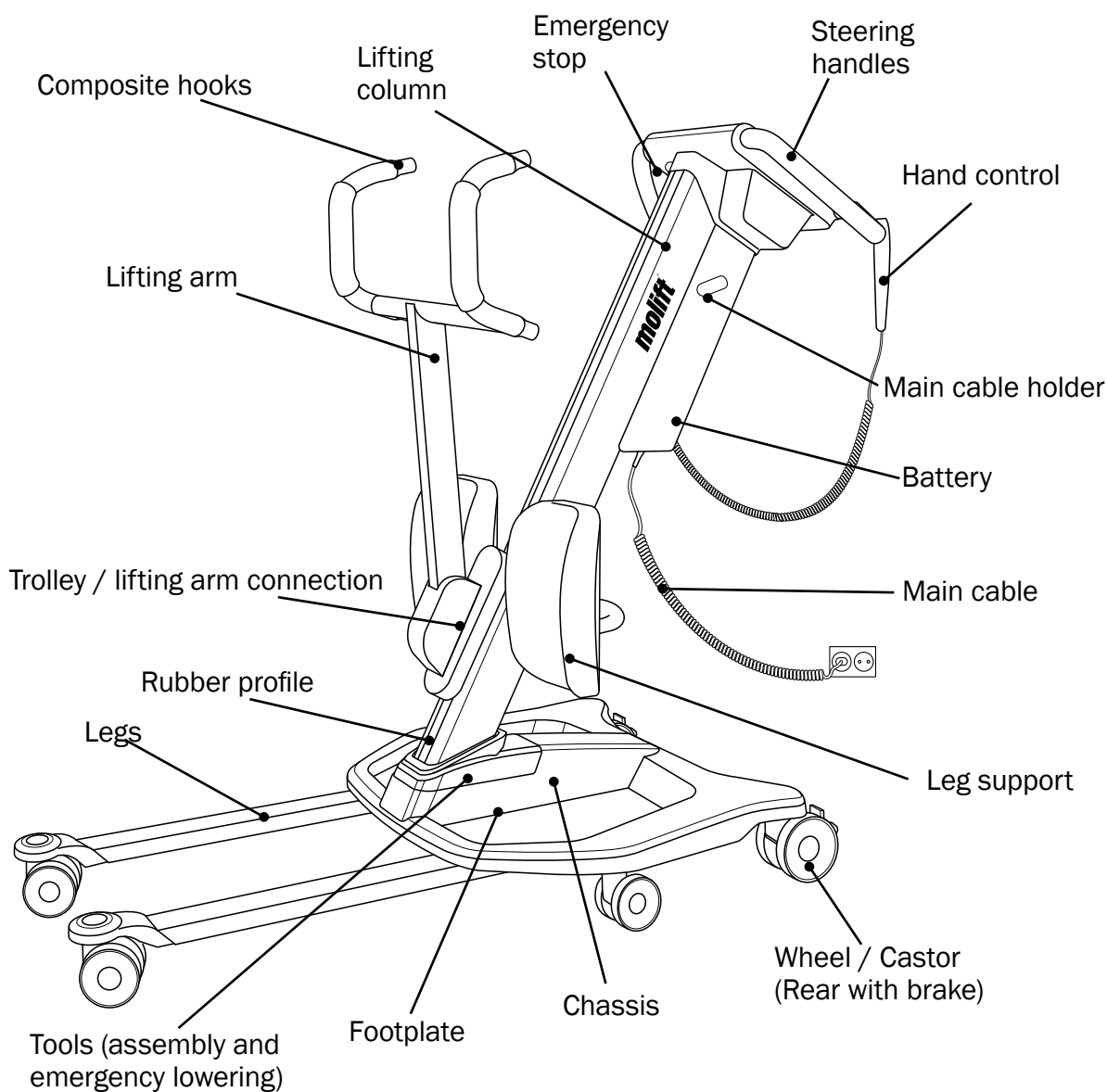

Product label

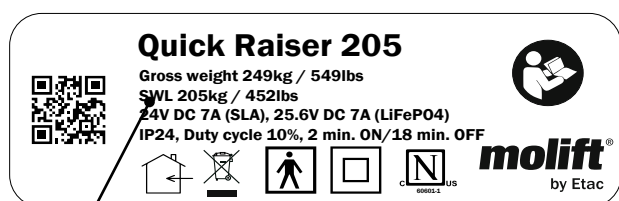

SWL value

ID label



Serial no.

Article no.

Production date

A copy of this document is available for download at www.etac.com.

Scan QR code on product label for accessing product home page. The user manual can be found in the document section.

Article no. (see ID label):

.....

Serial no. (see ID label):

.....

Production Year:

.....

Owner:

.....

Sling shall be inspected separately and is not included in this inspection.

Situation of use

- Home
- Hospital
- Nursing home
- Other

 **The periodic inspection is to be performed by a person who is suitable and properly qualified and well acquainted with the design, use and care of the hoist**

 **The hoist's software Molift Service tool provides option to enter date of PI and name of inspector along with additional information. Molift recommends adding all observations / remarks concerning the hoist in the Molift Service tool for complete history log of the hoist**

Service light indicator (from 01.01.2018)

Note colour of service light indicator:

Status	Service light	Mode
	No light	No service needed
	Green flashing	Order service
	Yellow	Periodic inspection required
	Red	Perform service
	Red (and sound when activated)	Perform service immediately

Service light indicator (until 31.12.2017)

Status	Service light	Mode
	No light	No service needed
	Yellow	Order service
	Yellow flashing	Periodic inspection required
	Red	Perform service
	Red (and sound when activated)	Perform service immediately

Visual examination

 **Visual examination of load bearing structure to make sure there is no damage, cracks, frays or deformation. All checkpoints must be checked to approve hoist for further use**

OK	Not OK
	Lifting column
	Lifting arm
	Composite hooks
	Lifting arm connection (remove cover for check)
	Legs
	Product label
	Plastic covers
	Rubber profile
	Hand control
	Control panel
	Wheels / castors

OK	Not OK
	Brakes on wheels / castors
	Cables
	Battery
	Other electronics
	Leg support
	No corrosion
	Leg spreading mechanism
	Weldings
	Instruction for use / user manual is present / available

Functional examination



Test FUNCTION and inspect for wear and damage. All checkpoints must be checked to approve hoist for further use

OK	Not OK
	Wheels / castors
	Wheel / castor brakes
	With legs in inner position (parallel): Check that the distance between legs can not decrease when pushed together by hand
	Lifting column is completely fixed
	Emergency stop button is fully operational and interrupts power when engaged. Reset switch
	Electrical emergency lowering
	Tool for manual emergency lowering
	Electrical emergency lowering
	Hand control (all buttons, strain relief on hand control cable, hook, and battery indicator)
	Control panel (all buttons, excluding electrical emergency lowering)
	If all points so far are "OK", hoist shall be tested with SWL

OK	Not OK
	Perform one lifting cycle with weight equal to 75% SWL (see product label for value kg/lbs). Motor and spindle or must not slip when loaded (causing lifting arm to lower), and movement must be smooth and even
	Leg spreading mechanism, outer and inner position with SWL
	Perform new visual control; Damage, play and deformations as described above. Any damaged parts must be repaired or replaced and test is repeated once more until the hoist performs correctly
	Battery. With fully charged battery inserted, after initial cycle, battery light is full green, and wrench/service light is OFF

Accessories:

.....

.....

.....

Performed by

Full name:

Date/Place:

Signature:

Approved without faults

Next inspection (YYYY / MM):/.....

Perform "Reset of hoist"

Hoist is marked with "Out of order" and sent for repair

Hoist is not eligible for repair and taken out of service

If periodic inspection reveals any defect, wear or other damage that jeopardises the safety of the patient the hoist may not be used until the deficiency has been eliminated

The owner is notified



Due to legal requirements this document or a copy must be filed with the owner's service log book

If approved without faults, apply inspection label and mark with month and year for **next** inspection. When ordering label, use item no. 1100306

CONTROL

12 Month



molift®

Mark label with month and year for next inspection

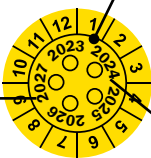

Next periodic inspection

Inspection performed by:

Reset of hoist



Ensure hoist is ON and emergency stop is deactivated.

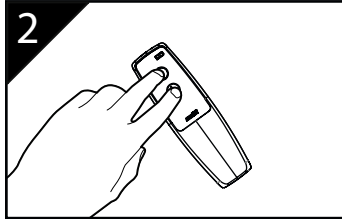

Press and hold both buttons for approx. 4 sec.:
First beep - when start pressing.
Second beep - stop pressing.

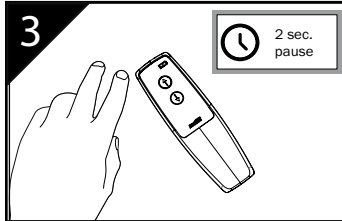

Pause for approx. 2 sec.

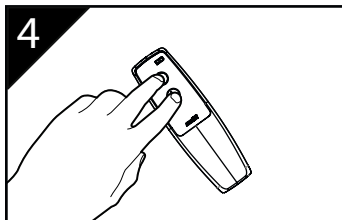

Press and hold both buttons for approx. 4 sec.:
First beep(s) - stop pressing.
Inspection indicator light is OFF - reset complete.

Notes and observations

.....