

2Move Display

Installation guide

immedia
by Etac

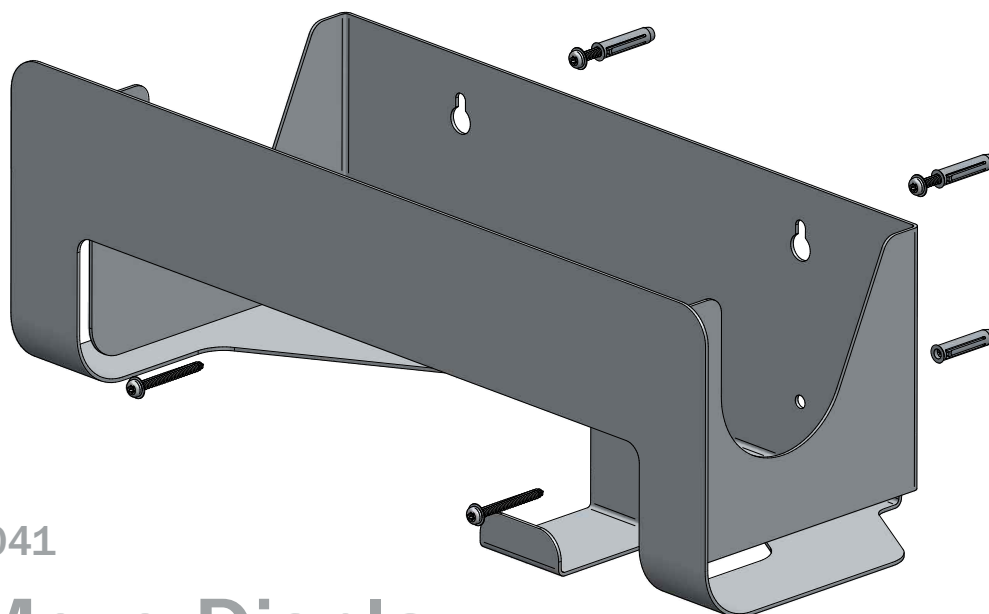

IM4041

2Move Display

Installation guide for 2Move Display

Use the template on the back of this sheet, to mark the position of the 4 holes.

Drill 4 holes, with a diameter of 8 mm and a minimum depth of 50 mm.

Mount the 4 supplied fasteners in their holes.

Mount screws and washers in the top fasteners and hang the display on them.

Mount screws and washers in the lower 2 fasteners and tighten all 4 screws.

Item no	Article name	Description	GTIN no	Size in mm
IM4041	2Move Display	For 2Move Board + Disposable Cover	05708012004508	H204xW531xL250

Manufacturer:

Etac AB
Etac Immedia A/S
Egeskovvej 12
DK-8700 Horsens
Denmark
Web: www.etac.com

etac[®]
Creating Possibilities

Hole Size Ø 8 mm x 50 mm



260 mm



Keep this line level

100 mm



imedia
by Etac