

Compatibility Check for Rear Linking System Klaxon® - Twist



Table of contents



Compatibility Check for Foldable Wheelchair

- Warnings Page 2
- Measuring the height of the centre of the wheel axle in relation to the ground Page 3
- Choosing the connection bracket Page 4
- Defining the crossbeam’s length Page 5
- How to identify the correct cup for the lateral fixing Page 7



Compatibility Check for Rigid Wheelchairs with Cambered Axle

- Warnings Page 13
- Measuring the height of the centre of the wheel axle in relation to the ground Page 14
- Choosing the connection bracket Page 15
- Measuring the diameter of the cambered axis Page 16
- Choosing the shims Page 17

Compatibility Check for Foldable Wheelchairs

Warnings

KLAXON®

	Perform the measurements with inflated tyres
	Carry out the measurements with the User sitting on the wheelchair or by using a weight equivalent to the User's

The parameters described on the following pages must be measured and checked in order to identify the components that allow the Twist to be fitted to the rear of foldable wheelchairs.

Compatibility Check for Foldable Wheelchairs

Measuring the height of the centre of the wheel axle in relation to the ground

KLAXON®

- Take the measurement of the wheel axle on the inner side of the wheelchair (H)

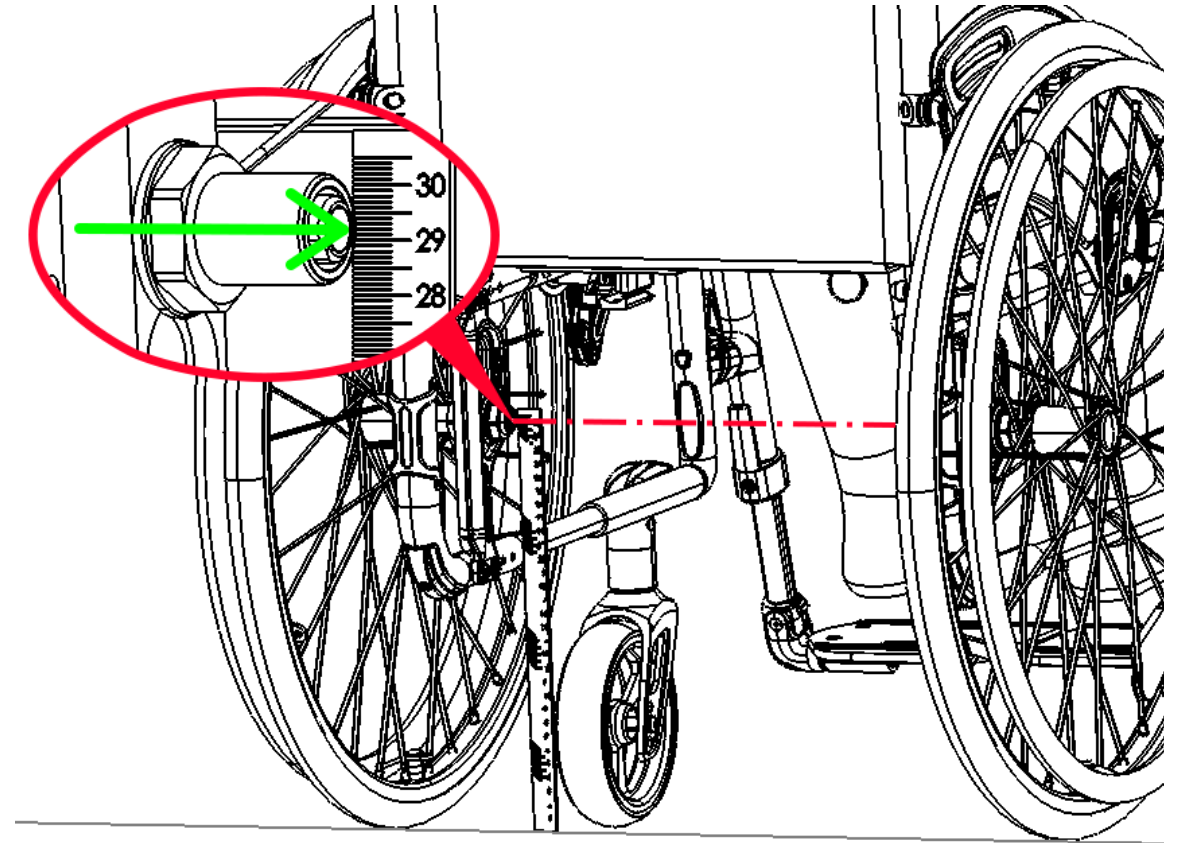

Compatibility Check for Foldable Wheelchairs

Choosing the connection bracket



There are 4 connection brackets available designed to fit 4 wheel sizes: 22, 24, 25 and 26 inches.

Still, depending in the chair configuration there could be exceptions in the fitting (e.g. cambered wheels, special tires, etc.). For this reason, it is recommended to choose the brackets by using the measurement H taken previously.

The table besides shows the range of distance covered by each bracket.

H [mm]	Product code
266 – 291	KT-22-0000-22 KT-23-0000-22
289 – 304	KT-22-0000-24 KT-23-0000-24
296 – 321	KT-22-0000-25 KT-23-0000-25
303 - 336	KT-22-0000-26 KT-23-0000-26

Compatibility Check for Foldable Wheelchairs

Defining the crossbeam's length

KLAXON®

- Measure the distance between the wheel axle nut's brackets to determine the crossbeam length

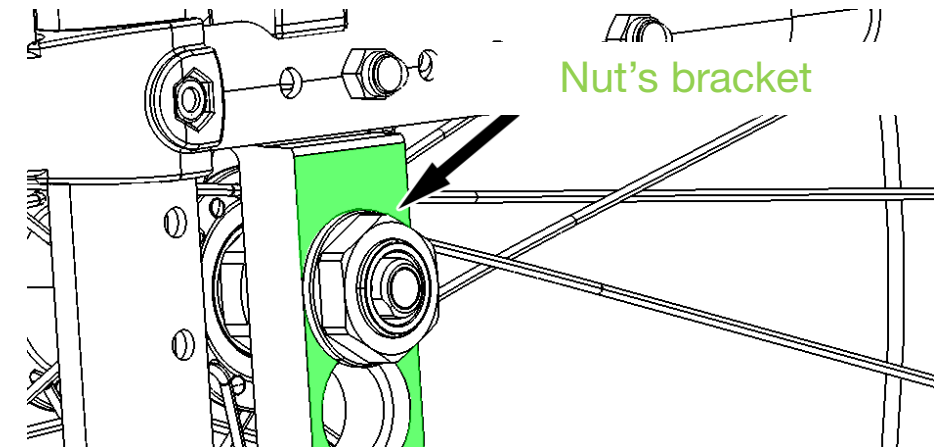
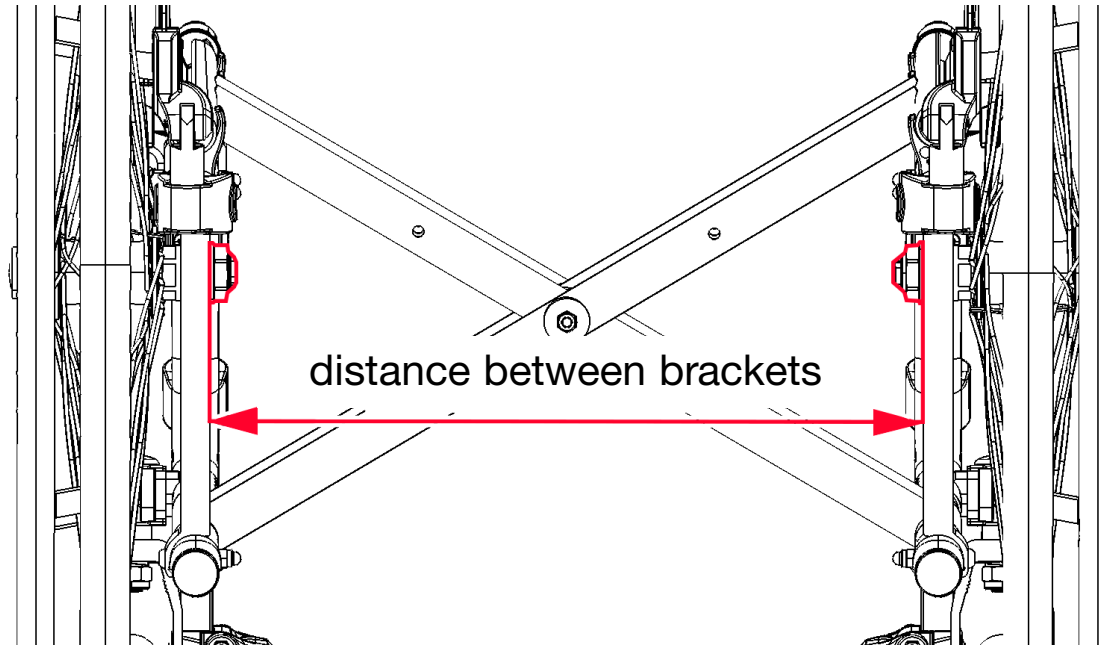

Compatibility Check for Foldable Wheelchairs

Defining the crossbeam's length



- Depending on the measured distance, choose the most suitable product code from the following table:

Distance between brackets [mm]	Product code
330-360	FOLD3336
361-390	FOLD3639
391-420	FOLD3942
421-450	FOLD4245
451-480	FOLD4548
481-510	FOLD4851

Compatibility Check for Foldable Wheelchairs

How to identify the correct cup for the lateral fixing

KLAXON®

- The crossbeams are delivered with a set of 9 pairs of cups. Choose from these the one that best fits the wheelchair
- There are cups available for mounting on **unthreaded pivots**, **threaded pivots** and **hexagonal nuts**

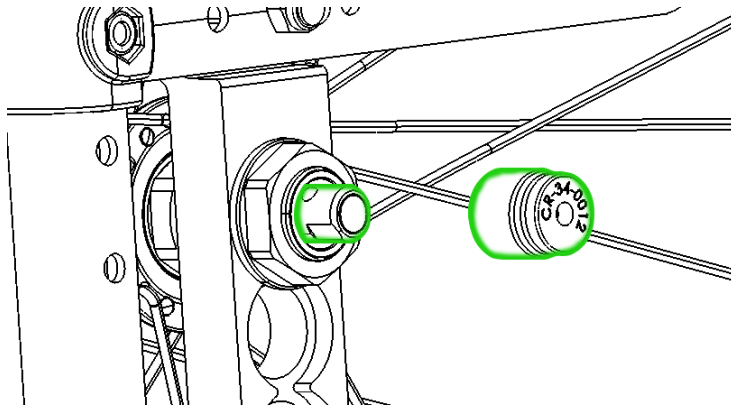

Mounting on unthreaded pivots

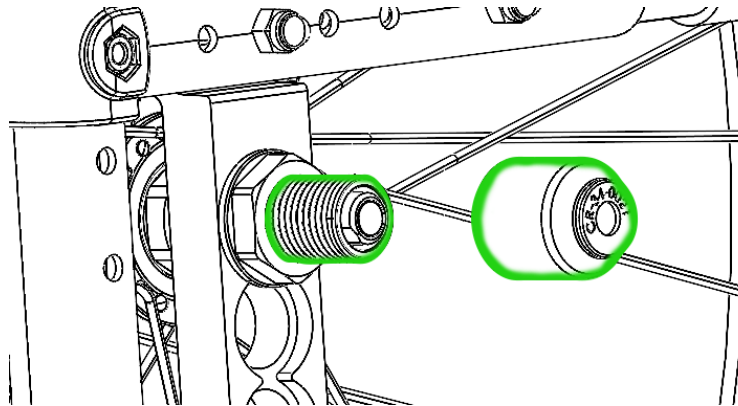

Mounting on threaded pivots

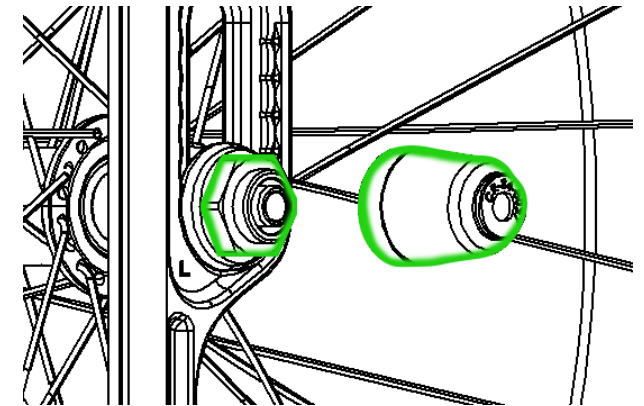

Mounting on hexagonal nuts

Compatibility Check for Foldable Wheelchairs

How to identify the correct cup for the lateral fixing

KLAXON®

Special scenarios:

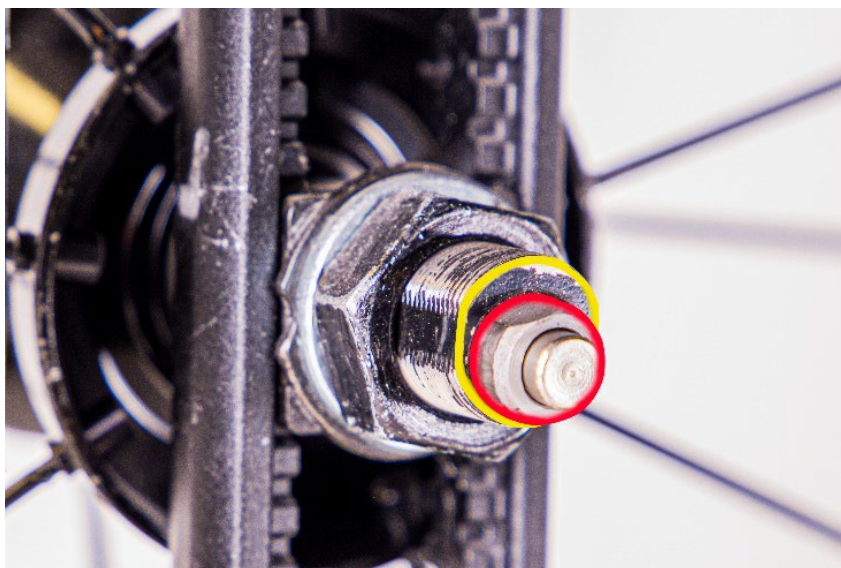

Foldable wheelchair with camber.

Solution: Mount the crossbeams on the threaded pivot or nut.



Nut too close to the frame tube.

Solution: Mount the crossbeams on the threaded pivot.

Compatibility Check for Foldable Wheelchairs

How to identify the correct cup for the lateral fixing

KLAXON®

1st Scenario - Mounting on unthreaded pivots

- The diameter of the unthreaded pivot is measured by identifying the dimension D

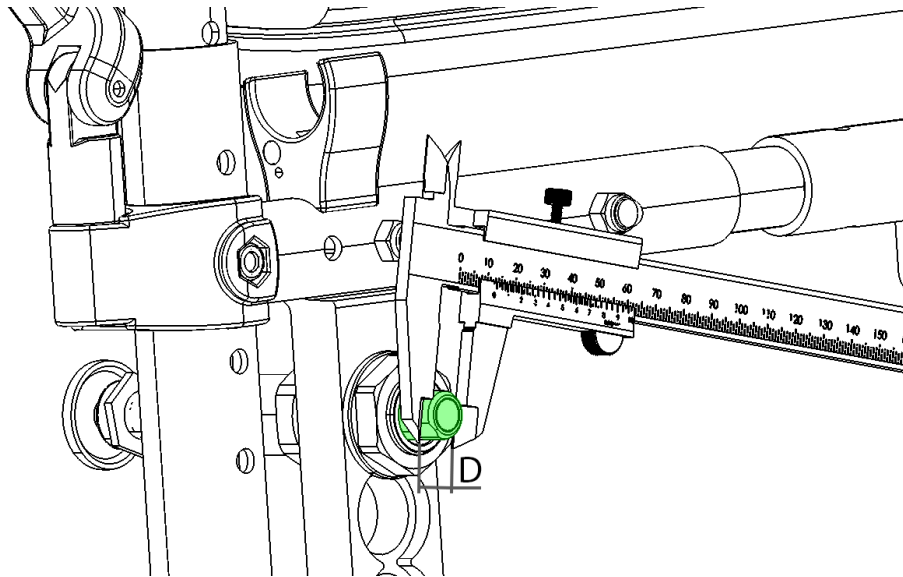

- Then choose the most suitable cup code:

Pivot diameter measurement D [mm]	Product code
Ø12	CR-34-0012
Ø12,7	CR-34-0013

Compatibility Check for Foldable Wheelchairs

How to identify the correct cup for the lateral fixing

KLAXON®

1st Scenario - Mounting on unthreaded pivots



Check that there is no overlapping between the axle's lock balls and the cups by fitting them together. If there is overlap, as shown below, try with the next methods proposed for threaded pivots or hexagonal nuts.

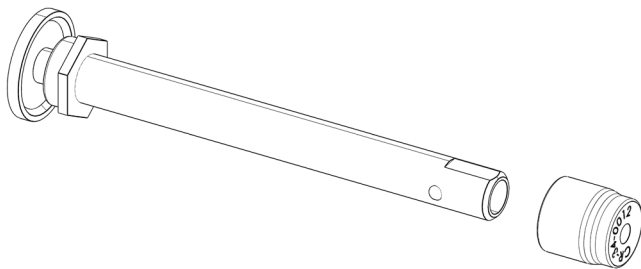

OVERLAP

NO

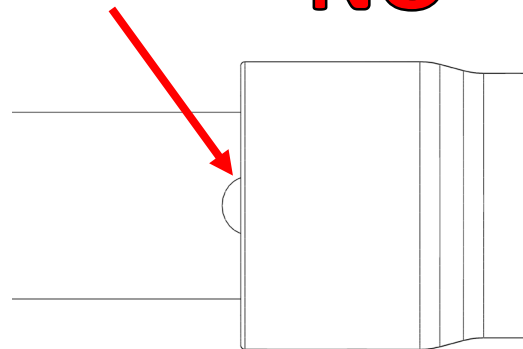

NO
OVERLAP

OK

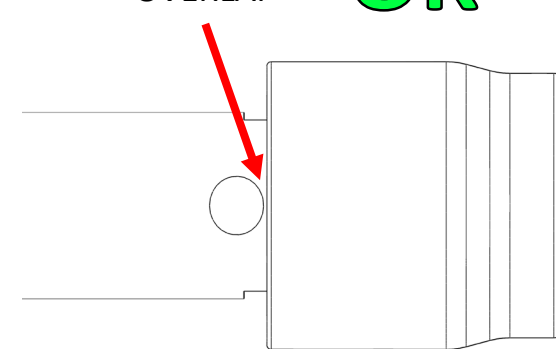

Compatibility Check for Foldable Wheelchairs

How to identify the correct cup for the lateral fixing

KLAXON®

2nd Scenario - Mounting on threaded pivots

- The diameter of the threaded pivot is measured by identifying the dimension D

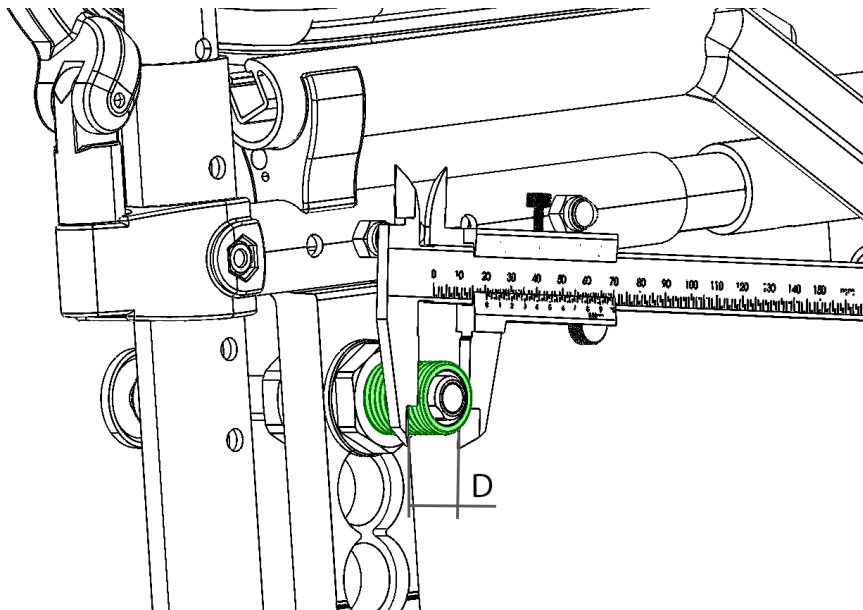

- Then choose the most suitable cup code:

Pivot Diameter measurement D [mm]	Product code
< Ø16,5	CR-34-0016
Ø16,5-17,5	CR-34-0017
Ø17,5-18,5	CR-34-0018
Ø18,5-21,2	CR-34-0021

Compatibility Check for Foldable Wheelchairs

How to identify the correct cup for the lateral fixing

KLAXON®

3rd Scenario - Mounting on hexagonal nuts

- The nut is measured between two opposite edges as in the figure below, thus identifying the dimension N (nut)

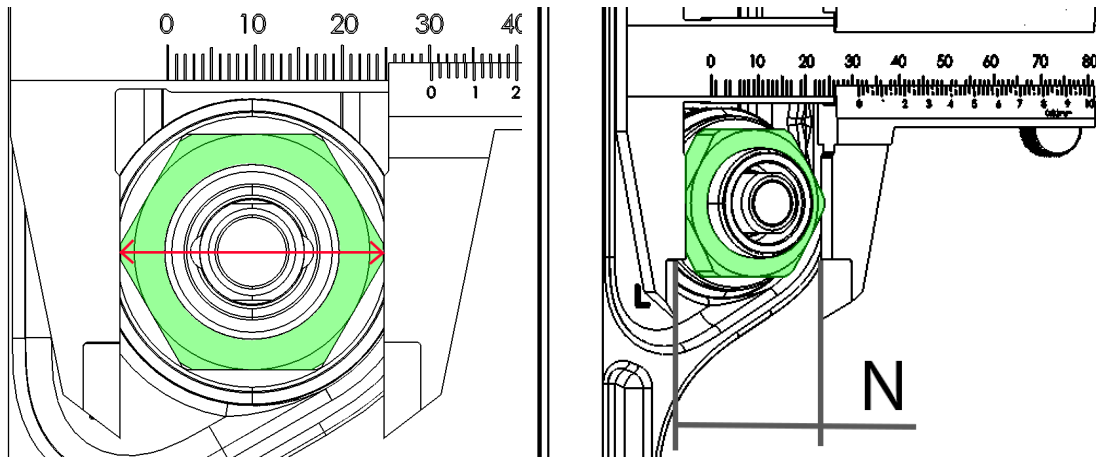

- Then choose the most suitable cup code:

Measured nut size N [mm]	Product code
< 25,5	CR-34-0025
25,6-27,5	CR-34-0027
27,6-30,5	CR-34-0030

Compatibility Check for Rigid Wheelchairs with Cambered Axle

KLAXON®

Warnings



Carry out the measurements with the user sitting on the wheelchair or by using a weight equivalent to the User's

The parameters described on the following pages must be measured and checked in order to identify the components that allow the Twist to be fitted to the rear of rigid wheelchairs.

Compatibility Check for Rigid Wheelchairs with Cambered Axle

KLAXON®

Measuring the height of the centre of the wheel axle in relation to the ground

- Measure the height of the centre of the cambered axle from the ground (H). Take the measurement on the central part of the axle.

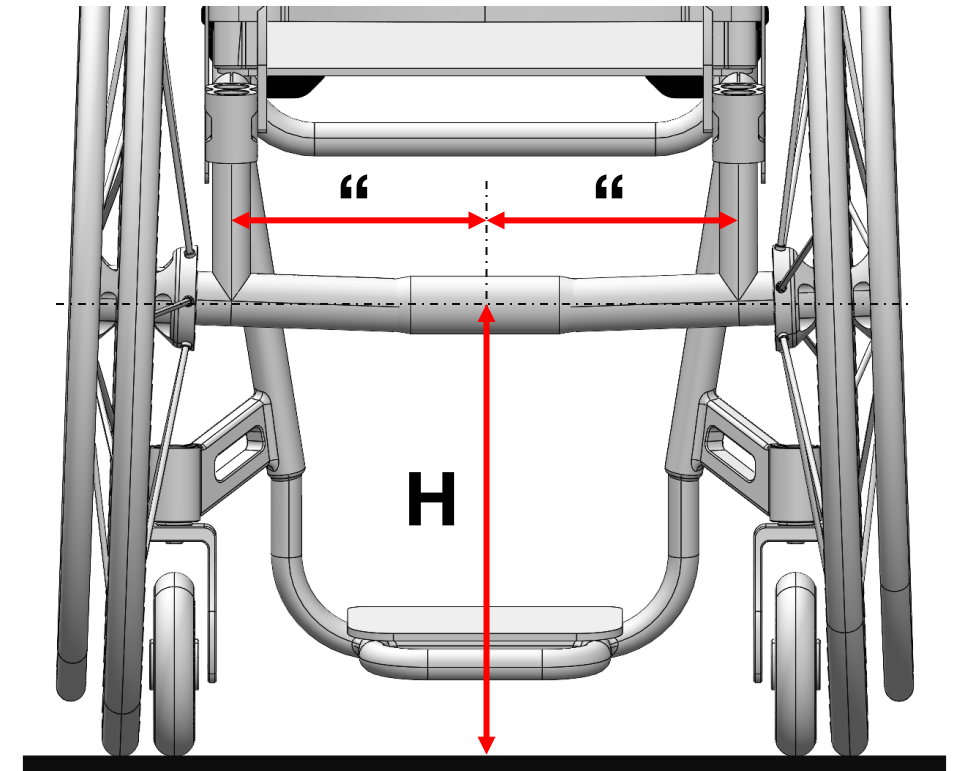

Compatibility Check for Rigid Wheelchairs with Cambered Axle



Choosing the connection bracket

There are 4 connection brackets available designed to fit 4 wheel sizes: 22, 24, 25 and 26 inches.

Still, depending in the chair configuration there could be exceptions in the fitting (e.g. cambered wheels). For this reason, it is recommended to choose the brackets accordingly to the measurement H taken in the previous page.

The table besides shows the range of distance covered by each bracket.

H [mm]	Product code
266 – 291	KT-23-0000-22
289 – 304	KT-23-0000-24
296 – 321	KT-23-0000-25
303 - 336	KT-23-0000-26

Compatibility Check for Rigid Wheelchairs with Cambered Axle

KLAXON®

Measuring the diameter of the cambered axle

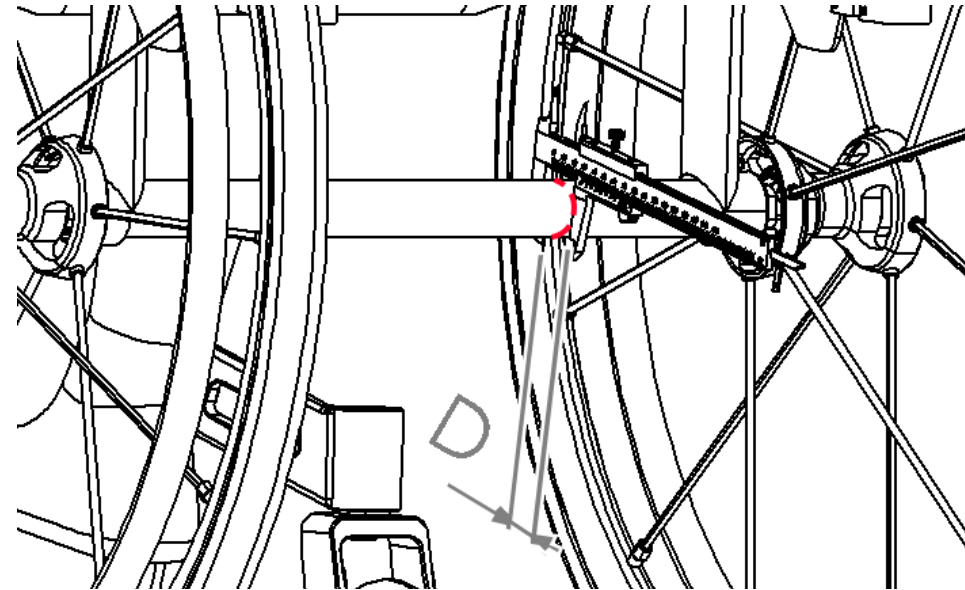
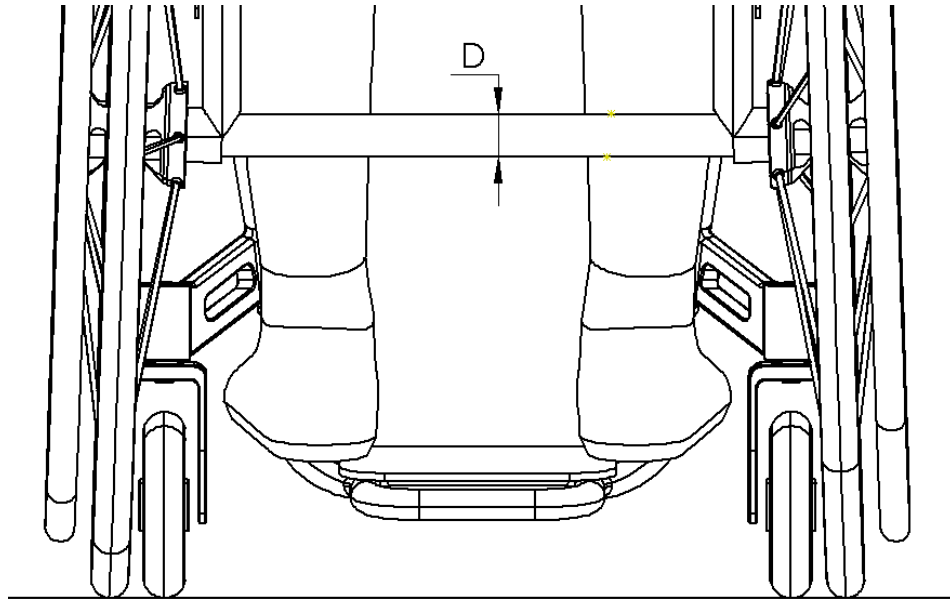

Compatibility Check for Rigid Wheelchairs with Cambered Axle

Choosing the shim

With the measured diameter D, it is now possible to choose the correct shim (if needed). The following table shows the shim correspondent to each measured axle diameter D;

Product code according to axle diameter D [mm]					
Ø36	Ø35	Ø32	Ø30	Ø28	Ø25
SHIM NOT REQUIRED	RID36-35-0000	RID36-32-0000	RID36-30-0000	RID36-28-0000	RID36-25-0000

KLAXON®



RID36-**-0000



The art of moving