

Turner Pro

etac®

EN - Recycling Instructions

RI61001 Rev A. 2022-09-30

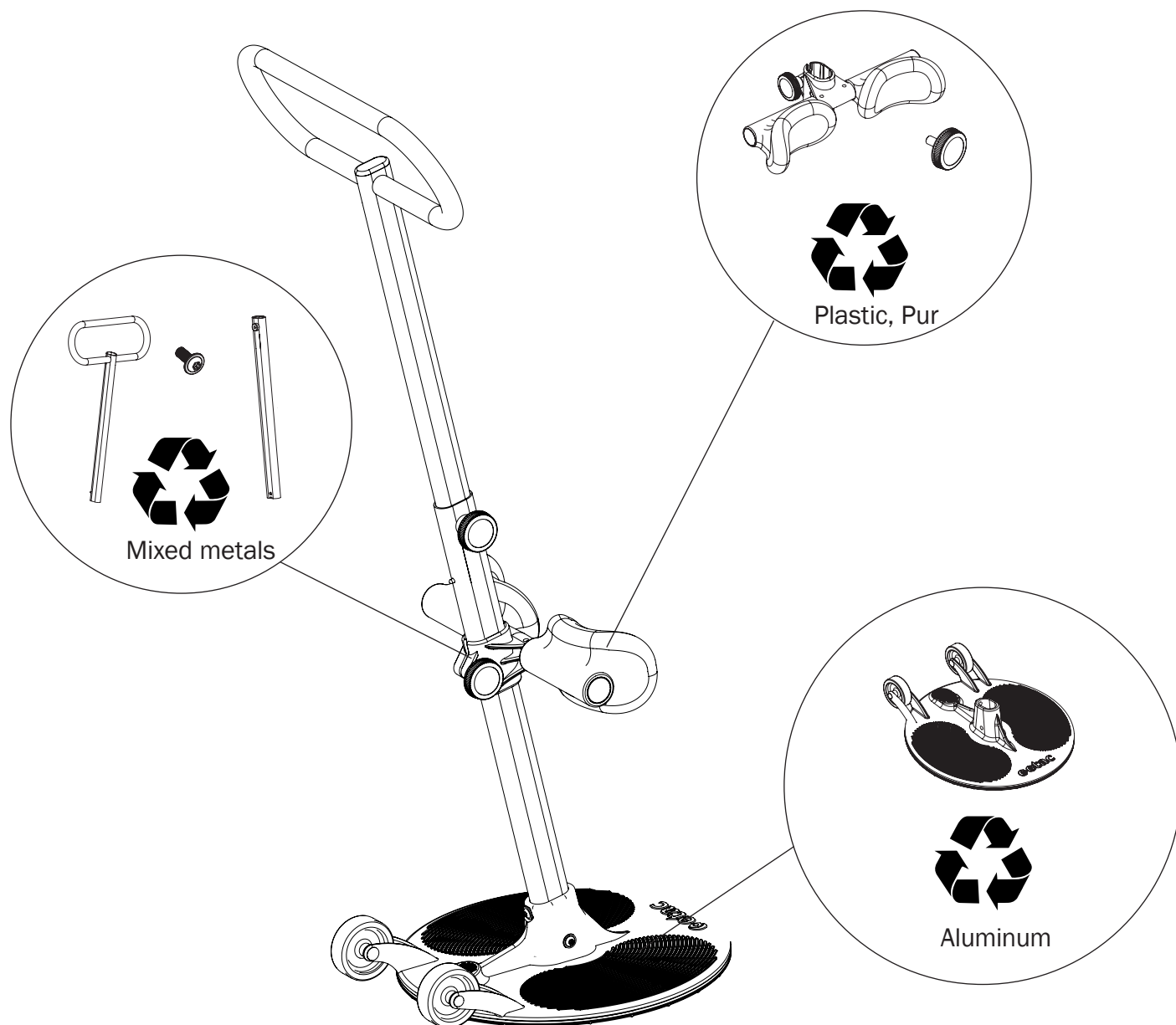

Etac A/S
Parallevej 3
DK-8751 Gedved
www.etac.com

Screws and steel rod inside the knee support should be recycled with mixed metals.

The bottom plate is made out of plastic and should be recycled with knee support, turning knobs and wheels

Wheels, are made of recyclable plastics (e.g. polypropylen and rubber) and can be removed from the main plate and recycled seperately.