

Molift Quick Raiser 1, 2, and 2+

molift[®]
by Etac

Periodic inspection checklist (EN)

In accordance with ISO:10535

PI04101 Rev. C 2022-06-13

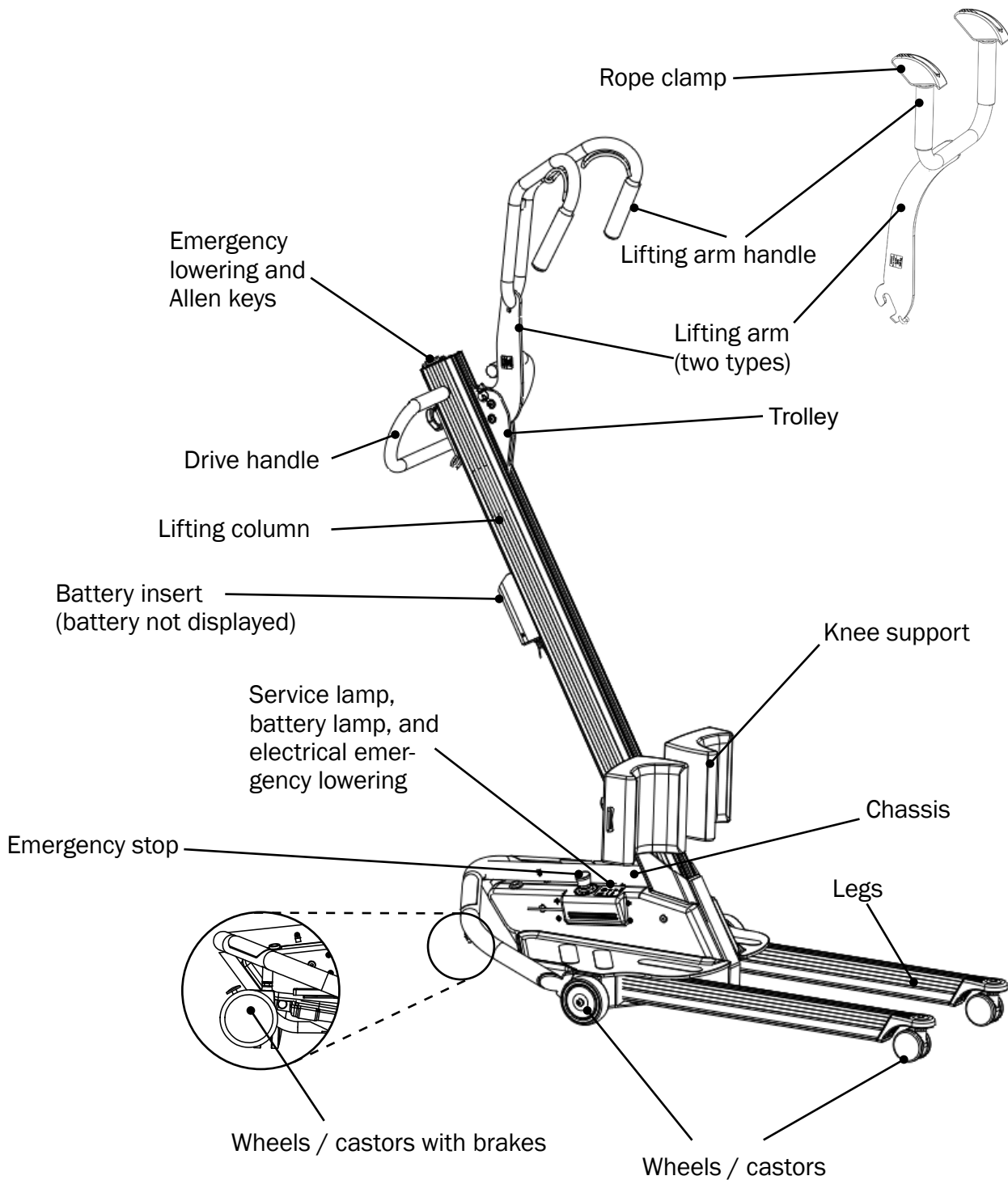

Product labels

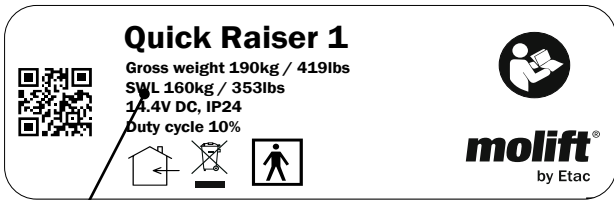

SWL value

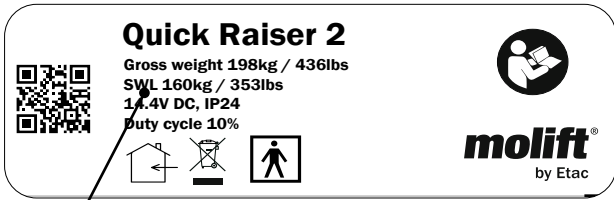

SWL value



SWL value

ID label



Serial no.

Article no.

Production date

A copy of this document is available for download at www.etac.com.

Scan QR code on product label for accessing product home page. The user manual can be found in the document section.

Article no. (see ID label):

.....

Serial no. (see ID label):

.....

Production Year:

.....

Owner:

.....

Sling shall be inspected separately and is not included in this inspection.

Specify model:

- Quick Raiser 1
- Quick Raiser 2
- Quick Raiser 2+

Service light indicator

Note colour of service light indicator:

Status	Service light	Mode
	No light	Power saving
	Green	Ready for use
	Yellow	Order service
	Red	Perform service
	Red (and sound when activated)	Perform service immediately

Situation of use

- Home
- Hospital
- Nursing home
- Other

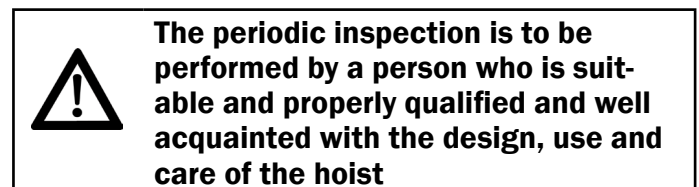

 **The hoist's software Molift Service tool provides option to enter date of PI and name of inspector along with additional information. Molift recommends adding all observations / remarks concerning the hoist in the Molift Service tool for complete history log of the hoist**

Visual examination

 **Visual examination of load bearing structure to make sure there is no damage, cracks, frays or deformation. All checkpoints must be checked to approve hoist for further use**

OK	Not OK
	Lifting column
	Lifting arm
	Lifting arm connection
	Robe clamps
	Lifting arm handles
	Lifting arm connection (trolley)
	Legs
	Product label
	Rubber profile
	Hand control
	Control panel
	Wheels / castors
	Brakes on wheels / castors
	Cables
	Battery
	Charger
	Other electronics
	Knee support
	Leg spreading mechanism
	No corrosion
	Weldings
	Instruction for use / user manual is present / available

Functional examination

 **Test FUNCTION and inspect for wear and damage. All checkpoints must be checked to approve hoist for further use**

OK	Not OK
	Wheels / castors
	Wheel / castor brakes
	With legs in inner position (parallel): Check that the distance between legs can not decrease when pushed together by hand
	Emergency stop button is fully operational and interrupts power when engaged. Reset switch
	Electrical emergency lowering
	Tool for manual emergency lowering
	Manual emergency lowering
	Hand control (all buttons, strain relief on hand control cable, hook, and battery indicator)
	If all points so far are "OK", hoist shall be tested with SWL.
	Perform one lifting cycle with weight equal to 75% SWL (see product label for value kg/lbs). Motor and spindle or must not slip when loaded (causing lifting arm to lower), and movement must be smooth and even
	Leg spreading mechanism, outer and inner position with SWL
	Perform new visual control; Damage, play and deformations as described above. Any damaged parts must be repaired or replaced and test is repeated once more until the hoist performs correctly
	Charger is operational
	Battery. With fully charged battery inserted, after initial cycle, battery light is off, and wrench/service light is green

Accessories:

.....

.....

.....

Performed by

Full name:

.....

Date/Place:

.....

Signature:

.....

Approved without faults

Next inspection (YYYY / MM):/.....

Hoist is marked with "Out of order" and sent for repair

Hoist is not eligible for repair and taken out of service

If periodic inspection reveals any defect, wear or other damage that jeopardises the safety of the patient the hoist may not be used until the deficiency has been eliminated

The owner is notified

 **Due to legal requirements this document or a copy must be filed with the owner's service log book**

If approved without faults, apply inspection label and mark with month and year for **next** inspection. When ordering label, use item no. 1100306

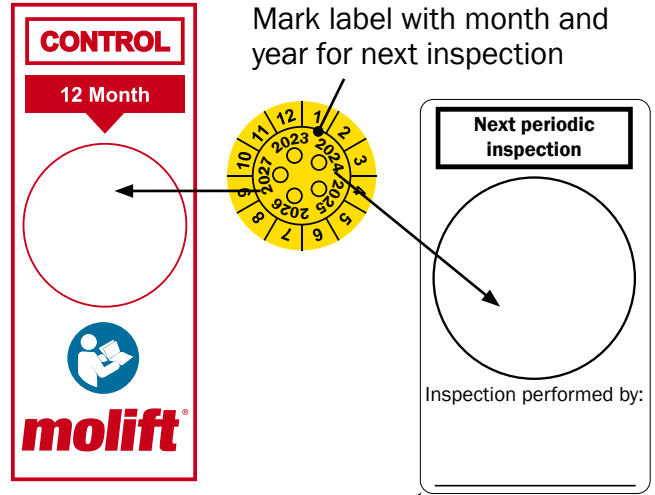

Mark label with month and year for next inspection

Next periodic inspection

Inspection performed by:

Notes and observations

.....